

DRIVEWAY PERMIT APPLICATION

TO: THE UPSHUR COUNTY COMMISSIONERS COURT
COUNTY OF UPSHUR
GILMER, TEXAS

PRECINCT 1

DATE December 16, 2024

Formal notice is hereby given that Clint Sims, whose principal address is 10480 Mallard Rd, does hereby propose to place a driveway culvert within the ROW of County Road Mallard. Proposed construction will begin, if approved, on or after the 30th day of December, 20 24. I, Clint Sims, hereby attest that I have read the conditions set forth in this application and understand its contents. The culvert X will/ will not be placed by County equipment and personnel. This is a X new installation extension.

SIGNATURE: 

TELEPHONE: 903-830-2291

APPROVAL OF PERMIT APPLICATION

The Upshur County Commissioners Court offers no objection to the location on the right of way of your proposed driveway culvert for the address shown above. The proposed driveway structure will be a 15" x 24" culvert.

Recommended by: 

APPROVED ON THIS 17 DAY OF 12, 20 24

X 15x24 recommended by Gary

APPROVAL

TO: Charter-Spectrum
6060 N Central Expwy, Suite 400
Dallas, TX 75206

DATE December 19, 2024

The Upshur County Commissioners Court offers no objections to the location on the right-of-way of your proposed 2" HDPE conduit line across Bamboo, Red Maple, Sycamore, Red Cedar, Spruce, Brown, Beech, Aspen Trl Road as shown by accompanying drawings and notice dated December 19, 2024, except as noted below:

N/A

It is expressly understood that the Upshur County Commissioners Court does not purport, hereby, to grant and right, claim, title, or easement in or upon this county road; and it is further understood that in the future should for any reason Upshur County need to work, improve, relocate, widen, increase add to or any manner change the structure of this right-of-way line, this line, if affected, will be moved under the direction of the Upshur County Engineer and shall be relocated at the complete expense of the owner. Upshur County shall be notified a minimum of 48 hours prior to the beginning of any work.

All work on the county right-of-way shall be performed in accordance with the County Engineer's instructions. The installation shall not damage any part of the highway and adequate provisions must be made to cause minimum inconvenience to traffic and adjacent property owners. Special specifications for placing this line are as follows:

1. All ground lines are to be installed a minimum of 36 inches below the flowline of the adjacent drainage or borrow ditch.
2. All excavations within the right-of-way and not under surfacing shall be backfilled by tamping in 6 inch horizontal layers. All surplus material shall be removed from the right-of-way and the excavation finished flush with surrounding natural ground.
3. Lines crossing under surfaced roads and under surfaced cross roads within the right-of-way shall be placed by boring. Boring shall extend from crown line to crown line.
4. All lines under roads carrying pressure in excess of 50 psi shall be enclosed in satisfactory casing extending from right-of-way line to right-of-way line. Pipe used for casing may be of any type approved by the County Engineer and shall be capable of Supporting the load of roadbed and traffic and shall be so constructed that there will be no leakage of any matter through the casing for its entire length. Inside diameter of casing shall be at least 2 inches greater than the largest outside diameter of carrier pipe, joint or couplings. (Encasement is not required on lines installed 48 inches or greater below flowline.)
5. All lines, where practicable, shall be located to cross roadbed at approximately right angles thereto. No lines are to be installed under or within 50 feet of either end of a bridge unless approved by the County Engineer in writing. No lines shall be placed inside any culvert or within 10 feet of the closest point of same.
6. Parallel lines will be installed as near the right-of-way lines as is possible and no parallel line will be installed in the roadbed or between the drainage ditch and roadbed unless approved by the County Engineer in writing.
7. Overhead lines will have a minimum clearance of 18 feet above the road surface at point of crossing.
8. Operations along roadways shall be performed in such a manner that all excavated material be kept off the pavements at all times, as well as all operating equipment and materials. Do not use equipment or installation procedures which will damage any road surface or structure. The cost of any repairs to road surfaces, roadbed, structures or other right-of-way features as direct result of this installation will be borne by the owner of this line.
9. Barricades, warning signs, lights and flagmen, when necessary, shall be provided by the contractor or owner. One half of the traveled portion of the road must be open to traffic at all times. All traffic control shall be in accordance with the requirements of the current version of the Texas MUTCD.
10. Utility company shall install adequate erosion control measures for any excavation work being performed.

APPROVED: _____

Road Administrator

APPROVED: _____

Chairperson, Upshur County Commissioners Court
Revised 11/30/10

NOTICE OF PROPOSED INSTALLATION
PIPE AND/OR UTILITY LINES

DATE: 12/19/2024

TO: UPSHUR COUNTY COMMISSIONERS COURT
c/o UPSHUR COUNTY ENGINEER
UPSHUR COUNTY ROAD & BRIDGE DEPARTMENT
P. O. BOX 730
Gilmer, TX 75644

EXPIRES: _____

Formal notice is hereby given that Charter-Spectrum 1-2" HDPE Conduits
* _____ as follows: proposes to bore a _____ line within the right-of-way of County Road

* Bamboo Rd, Red Maple Rd, Sycamore Rd, Red Cedar Rd, Spruce Rd, Brown St, Beach Rd and Aspen Trail.

Charter-Spectrum proposes to install approx. 14,028 ft of underground conduit equipped with fiber optic cable, place approx twenty-one (21) vaults and place approx nine (9) pedestals within the rights of way of the aforementioned County Roads.

The location and description of the proposed line and appurtenances is more fully shown by three copies of drawings attached to this notice. The line will be constructed and maintained on the County right-of-way as directed by the County Engineer in accordance with current Upshur County specifications.

Construction of this line will begin on or after the 26th day of Dec, 2024 and will be completed within 90 days of the date of approval.

Firm Charter Spectrum
By Josh Lenker
Title Project Manager
Address 6060 N Central Expwy, Suite 400
Dallas, TX 75206

- NOTE: 1. This form to be submitted in triplicate for each proposed installation.
2. The permit shall be in effect until the utility line is removed from the right of way.
3. Inform the County Engineer if work is not completed within this time.

SHEET INDEX

1. COVER SHEET
2. GENERAL NOTES
- 3-28. CDP PLAN

PROJECT INFORMATION

CONTACT: CHARTER-SPECTRUM
CONTACT: OSCAR SOTO
PHONE: 469-503-8112
EMAIL: oscar.soto@charter.com

CONTACT:
KEN BAILEY, SR., PROJECT MANAGER
LJA ENGINEERING, INC
2150 S CENTRAL EXPY, SUITE 300
MCKINNEY, TX 75070
KBAILEY@LJA.COM
214-824-2500

Spectrum

RDOF_TX_CLUSTER_2_TBD_WI56E (3993829) UPSHUR COUNTY BIG SANDY, TX 75755

DECEMBER 11, 2024

SUBMITTAL PREPARED BY

LJA

LJA TELECOM

6000 N. Central Expressway, Suite 400
Dallas, TX 75208
469-421-0770
TYPE FOR REGISTRATION P-1308

CONTACT:
STUART CORWELL
PHONE:
817-438-4717

SUBMITTED FOR APPROVAL BY
DATE

12/11/2024
DATE

NOTE:
THE RIGHT-OF-WAY (ROW) SHOWN ON THESE PLANS
IS BASED ON PUBLICLY AVAILABLE INFORMATION
AND IS NOT EXACT. IT IS THE CONTRACTOR'S
RESPONSIBILITY FOR ENSURING THAT ALL
FACILITIES ARE CONSTRUCTED WITHIN THE ROW OR
IN A CONFORMANCE EASEMENT. THE
CONTRACTOR SHALL NOTIFY THE ENGINEER AND
THE OWNER PRIOR TO CONSTRUCTION IF THERE
ARE ANY CONCERNS REGARDING THE ROW.

LOCATION OF EXISTING
UNDERGROUND AND OVERHEAD
UTILITIES AND APPROXIMATE
LOCATIONS ONLY. THE
CONTRACTOR SHALL DETERMINE
THE EXACT LOCATION OF ALL
EXISTING UTILITIES PRIOR TO
BEGINNING WORK AND SHALL BE
FULLY RESPONSIBLE FOR ANY AND
ALL DAMAGES WHICH MIGHT OCCUR.



Know what's below.
Call before you dig.

SCOPE OF WORK

CHARTER COMMUNICATIONS PROPOSES TO INSTALL
AERIAL AND UNDER GROUND FIBER OPTIC CABLE
WITH 1-2" HDPE CONDUIT IN UPSHUR COUNTY
ALONG COUNTY ROADS BAMBOO RD, RED MAPLE
RD, STAMORE RD, RED CEDAR RD, SPRUCE RD,
BROWN ST, BEACH RD AND ASPEN TRAIL.

DESCRIPTION	UNIT	QUANTITY
DIRECTIONAL BORE	LF	14028
TRENCH	LF	
PULL EXISTING CONDUIT		
BORE PITS	EA	
NEW VAULTS	EA	21
NEW PEDESTALS	EA	9
POWER SUPPLY	EA	
AERIAL RISER	EA	
NEW STRAND	LF	32849
ANCHORS	EA	
NEW POLES	EA	
EXISTING POLES	EA	
TOTAL PROJECT FOOTAGE	LF	46877

LEGEND
AERIAL
UNDERGROUND

LOCATION MAP

NTS.

12/11/2024 2:28:01 PM S:\cadd\11\lujan\PROJECTS\CHARTER-SPECTRUM\TX_CLUSTER_2_TBD_WI56E\PROJECTS\CHARTER-SPECTRUM\TX_CLUSTER_2_TBD_WI56E\UPSHUR COUNTY NOTES.dwg

GENERAL NOTES

1. ALL EXISTING FACILITIES CURRENTLY IN SERVICE MUST REMAIN IN SERVICE, UNLESS OTHERWISE NOTED IN THE DRAWINGS.
2. CONDITION OF THE ROAD AND/OR RIGHT-OF-WAY, UPON COMPLETION OF JOB SHALL BE AS GOOD AS OR BETTER THAN PRIOR TO STARTING WORK.
3. ALL EFFORTS HAVE BEEN MADE TO INDICATE ALL EXISTING UTILITIES ON PLANS, IT SHALL BE THE CONTRACTORS RESPONSIBILITY TO LOCATE AND PROTECT ALL SAID UTILITIES AS WELL AS SERVICE CONNECTIONS (WHETHER OR NOT INDICATED ON PLANS). PRIOR TO CONSTRUCTION, CONTRACTOR SHALL COORDINATE WITH UTILITY COMPANIES TO VERIFY LOCATION OF EXISTING UTILITIES.
4. CALL UTILITY COORDINATING COMMITTEE 48 HRS. PRIOR TO CONSTRUCTION AT 1-800-344-8377 (1-800-DIG-TESS).
5. CONTRACTOR IS RESPONSIBLE FOR COORDINATING WITH GAS, OIL, ELECTRIC, TELEPHONE, FIBER OPTIC, CABLE TV, SEWER AND WATER UTILITIES OWNERS, ETC. FOR ANY RELOCATION AND/OR PROTECTION OF EXISTING LINES OR CABLES AS REQUIRED, DUE TO CONSTRUCTION ACTIVITIES.
6. CONTRACTOR TO PROVIDE A MINIMUM OF 2' OF CLEARANCE AT ALL CROSSINGS OF SANITARY SEWERS, STORM SEWERS, ELECTRIC, WATER LINES AND LEADS.
7. CONTRACTOR MUST COMPLY WITH OSHA SPECIFICATIONS, TXDOT STD. SPEC (DIVISION IV, STRUCTURES) AND UTILITY OWNER STANDARDS FOR TRENCHING, BACKFILLING, EXCAVATION AND SHORING REQUIREMENTS.
8. THE CONSTRUCTION CONTRACTOR SHALL ALSO BE SOLELY RESPONSIBLE FOR THE MEANS, METHODS, SEQUENCE, PROCEDURES, TECHNIQUES OR SCHEDULING ALL PORTIONS OF THE WORK OF CONSTRUCTION IN ACCORDANCE WITH THE CONTRACT DOCUMENTS. THE CONSTRUCTION CONTRACTOR SHALL ALSO BE SOLELY RESPONSIBLE FOR SAFETY IN OR ABOUT THE JOB SITE IN ACCORDANCE WITH ANY HEALTH OR SAFETY PRECAUTIONS, REGULATIONS, STANDARDS OR CODES REQUIRED BY O.S.H.A. OR ANY OTHER REGULATORY AGENCY.
9. NO MORE TRENCH OPENED AT ONE TIME THAN CAN BE BACKFILLED AND COMPACTED IN 8" LIFTS AT THE END OF EACH WORK PERIOD; NO TRENCH LEFT OPEN OVERNIGHT UNLESS COVERED BY METAL PLATES.
10. CONTRACTOR TO TAKE NECESSARY PRECAUTIONS TO PROTECT ROOT SYSTEMS OF SHRUBS, PLANTS AND TREES ALONG THE AREA OF EXCAVATION.
11. EXISTING PAVEMENT, CURBS, SIDEWALKS, AND DRIVEWAYS DAMAGED OR REMOVED DURING CONSTRUCTION SHALL BE REPLACED BY BONDED CONTRACTOR IN CONFORMANCE WITH LOCAL STANDARDS, WHEELCHAIR RAMPS SHALL BE CONSTRUCTED AT ALL PEDESTRIAN CROSSINGS WHERE CURB REMOVAL IS REQUIRED FOR INSTALLATION OF THE UNDERGROUND CONDUIT SYSTEM.
12. CONTRACTOR SHALL BE RESPONSIBLE FOR DETERMINING BORE PIT LOCATIONS AND DIMENSIONS, INFORMATION SHOWN ON PLANS ARE FOR REFERENCE PURPOSE ONLY.
13. IF IT BECOMES NECESSARY TO OPERATE MACHINERY ON A PORTION OF THE PAVEMENT, PRECAUTIONS MUST BE TAKEN TO PREVENT ANY DAMAGE WHATSOEVER TO THE PAVEMENT.
14. CONTRACTOR SHALL INSTALL TRAFFIC CONTROL DEVICES IN CONFORMANCE WITH PART VI OF THE TEXAS MANUAL ON UNIFORM TRAFFIC CONTROL DEVICES (2014 EDITION) AND TXDOT STANDARDS DURING CONSTRUCTION TO PROVIDE COMPLETE SAFETY TO THE GENERAL PUBLIC.

15. BORE PITS CLOSER THAN 15' FROM THE EDGE OF PAVEMENT MUST BE PROTECTED BY TYPE III BARRICADES. OPEN PITS MUST BE SEALED OFF BY ORANGE PLASTIC MESH FENCING AND CONES OR DRUMS.

16. CONSTRUCTION EQUIPMENT LEFT OVERNIGHT IN TXDOT RIGHT-OF-WAY SHALL BE SECTIONED OFF WITH ORANGE PLASTIC MESH FENCING AND BE PLACED AT LEAST 30' FROM THE EDGE OF PAVEMENT, EQUIPMENT LOCATED CLOSER THAN 30' MUST BE PROTECTED BY CONCRETE TRAFFIC BARRIERS (CTB'S).

17. CONTRACTOR WILL BE RESPONSIBLE FOR REPLACING AND MAINTAINING TRAFFIC SIGNS AND PAVEMENT MARKINGS, INCLUDING CENTERLINES, BARRIER LINES, LANE LINES, RAISED PAVEMENT MARKING, ECT.

18. CONTRACTOR IS REQUIRED TO PREPARE AND IMPLEMENT AN APPROVED STORM WATER POLLUTION PREVENTION (SWPP) PLAN IN ACCORDANCE WITH STATE AND LOCAL REQUIREMENTS AND CONTRACT DOCUMENTS. CONTRACTOR SHALL KEEP ALL DEBRIS & SPOIL OUT OF DRAINS, CULVERTS, AND DROP INLETS AND ENSURE THAT THEY DO NOT BECOME CLOGGED AS A RESULT OF CONSTRUCTION ACTIVITIES.

19. ANY DISCREPANCIES FROM WHAT IS SHOWN ON THE PLANS SHALL BE BROUGHT TO THE ATTENTION OF THE ENGINEER.

20. THE CONDUIT, FITTINGS, CONDUIT BODIES AND ACCESSORIES SHALL BE INSPECTED UPON DELIVERY AND DURING THE PROGRESS OF THE WORK. ANY MATERIAL FOUND TO BE DEFECTIVE WILL BE REJECTED BY THE OWNERS REPRESENTATIVE AND THE CONTRACTOR SHALL REMOVE SUCH DEFECTIVE MATERIAL FROM THE SITE OF THE WORK.

21. CONTRACTOR SHALL COORDINATE AND VERIFY ANY UTILITY ABANDONMENT WITH THE UTILITY COMPANY. NO FACILITY MAY BE CONSIDERED ABANDONED WITHOUT WRITTEN CONSENT FROM UTILITY OWNER.

22. CONTRACTOR IS TO PLUG ALL INSTALLED DUCTS.

23. THE CONSTRUCTION CONTRACTOR SHALL PLACE UTILITY LOCATION TAPE OVER ALL EXPOSED CONDUIT.

24. ALL PROPOSED BENDS SHALL BE GRADUAL SWEEPS WITH A MINIMUM 20-FOOT RADIUS, UNLESS NOTED ON THE PLANS.

25. CONTRACTOR SHALL CONSTRUCT HORIZONTAL DIRECTIONAL DRILL IN ACCORDANCE WITH ASTM F 1982 "STANDARD GUIDE FOR USE OF MAXI-HORIZONTAL DIRECTIONAL DRILLING FOR PLACEMENT OF POLYETHYLENE PIPE OR CONDUIT UNDER OBSTACLES INCLUDING RIVER CROSSINGS"

26. CONTRACTOR TO PROVIDE AND PLACE 2500LB MULE TAPE IN EACH INSTALLED DUCT.

27. ALL PROPOSED TELECOM FACILITIES SHOULD BE INSTALLED AT MIN DEPTH IS 48" FOR LONGITUDINAL LINES AND MIN DEPTH IS 60" FROM LOWEST POINT OF GRADE FOR CROSSINGS.

28. USE OF WATER AND OTHER FLUIDS IN CONNECTION WITH BORING OPERATIONS WILL BE PERMITTED ONLY IN SUFFICIENT QUANTITY TO LUBRICATE BORING BIT AND PROVIDE A SMOOTH FLOW OF CUTTINGS. JETTING WILL NOT BE PERMITTED.

29. OPERATIONS ON THE ROADWAY SHALL BE PERFORMED IN SUCH A MANNER THAT OPERATING EQUIPMENT AND EXCAVATED MATERIAL ARE KEPT OFF THE PAVEMENT AT ALL TIMES.

30. BARRICADES AND WARNING SIGNS, AND FLAGMEN WHEN NECESSARY, SHALL BE PROVIDED BY THE CONTRACTOR OR OWNER. ONE-HALF THE TRAVELED PORTION OF THE ROADWAY MUST BE OPEN TO TRAFFIC AT ALL

TIMES. CONTRACTOR TO REFER TO COMPLY WITH TEXAS MUTCD BARRICADE AND CONSTRUCTION STANDARDS.

31. WORK PERFORMED ON RAILROAD RIGHT-OF-WAY IS SUBJECT TO THE CONCURRENCE OF THE RAILROAD COMPANY. WORK PERFORMED WITHIN WATERWAYS, SUCH AS RIVERS, CREEKS, BAYOUS, AND DRAINAGE DITCHES IS SUBJECT TO THE RULES & REQUIREMENTS OF THAT APPROPRIATE GOVERNMENTAL AGENCY.

32. APPROPRIATE EASEMENT/APPROVAL MUST BE SECURED FOR PROJECT AREAS OUTSIDE THE RIGHT-OF-WAY. NO WORK SHALL BE PERFORMED ON PRIVATE PROPERTY UNTIL RIGHT OF ENTRY AND EASEMENT HAS BEEN OBTAINED.

33. CONTRACTOR TO CONTACT TELECOM OWNER A MINIMUM OF 2-WEEKS PRIOR TO CONSTRUCTION.

34. ALL FIBER OPTIC CABLE AND COOPER BASED FACILITIES WILL BE SPLICED BY THE UTILITY OWNER. CONTRACTOR SHALL BE RESPONSIBLE FOR NOTIFYING PERTINENT UTILITIES OF CONDUIT STRUCTURE COMPLETION FOR INSPECTION APPROVAL.

35. UTILITY CONTRACTOR TO CONTACT UTILITY OWNER OF 48 HOURS PRIOR TO CONNECTION TO EXISTING MANHOLE OR DUCTS TO COORDINATE ON-SITE INSPECTION BY UTILITY PERSONNEL.

36. CONTRACTOR TO PROVIDE OVERHEAD POLE SUPPORT WHENEVER CONSTRUCTION EXCAVATION IS WITHIN 5' OF AN OVERHEAD POLE.

37. CONTRACTOR MUST OBTAIN PERMISSION FROM AFFECTED PROPERTY OWNER FROM ANY CONSTRUCTION RELATED ACTIVITIES THAT MAY ENCRDACH ON ADJACENT PRIVATE PROPERTY.

38. CONTRACTOR SHALL BE RESPONSIBLE FOR NOTIFYING PERTINENT UTILITIES OF CONDUIT STRUCTURE COMPLETION FOR INSPECTION APPROVAL.

39. ONLY 1 STUD RIBER CONDUIT FOR EACH TELECOMMUNICATION PROVIDER AT ALL POLE LOCATIONS SHOWN ON PLANS.

40. ALL VAULTS, MANHOLES, AND HANDHOLES TO BE PLACED AT FINAL GRADES. TEMPORARY FILLS OR CUTS NEED TO BE USED AT EACH SITE SO THAT THE MINIMUM OF 2" WIDE LEVELING WORKING SPACE EXISTS AROUND THE PERIMETER OF EACH OPENING.

LOCATION OF EXISTING UNDERGROUND AND OVERHEAD UTILITIES AND APPROPRIATE LOCATIONS ONLY. THE CONTRACTOR SHALL DETERMINE THE EXACT LOCATION OF ALL EXISTING UTILITIES PRIOR TO BEGINNING WORK AND SHALL BE FULLY RESPONSIBLE FOR ANY AND ALL DAMAGES WHICH MIGHT OCCUR.



Spectrum

LJA

LJA TELECOM

SPECTRUM
3993829
ROOF_TX_CLUSTER_2_TBD_WI56E
UPSHUR COUNTY
GENERAL NOTES

DESIGN BY: LJA/T	CHECKED BY: J
DRAWN BY: RC	APPROVED BY: KB
PROJECT NO: 2605-24-WI32	SHEET: 3 OF 29
DATE: 12/11/2024	PAGE: 3

12/11/2024 2:24:41 PM S:\spectrum\laser\unplanned PROJECTS\CHARTER-SPECTRUM\WORTH TEXAS\2024\2605-24-N132 RD05_TX_CLUSTER_2_TBD_WI56E LJA TELECOM\unplanned COUNTY\unplanned COUNTY.dwg

BIG SANDY, TX
UPSHUR COUNTY

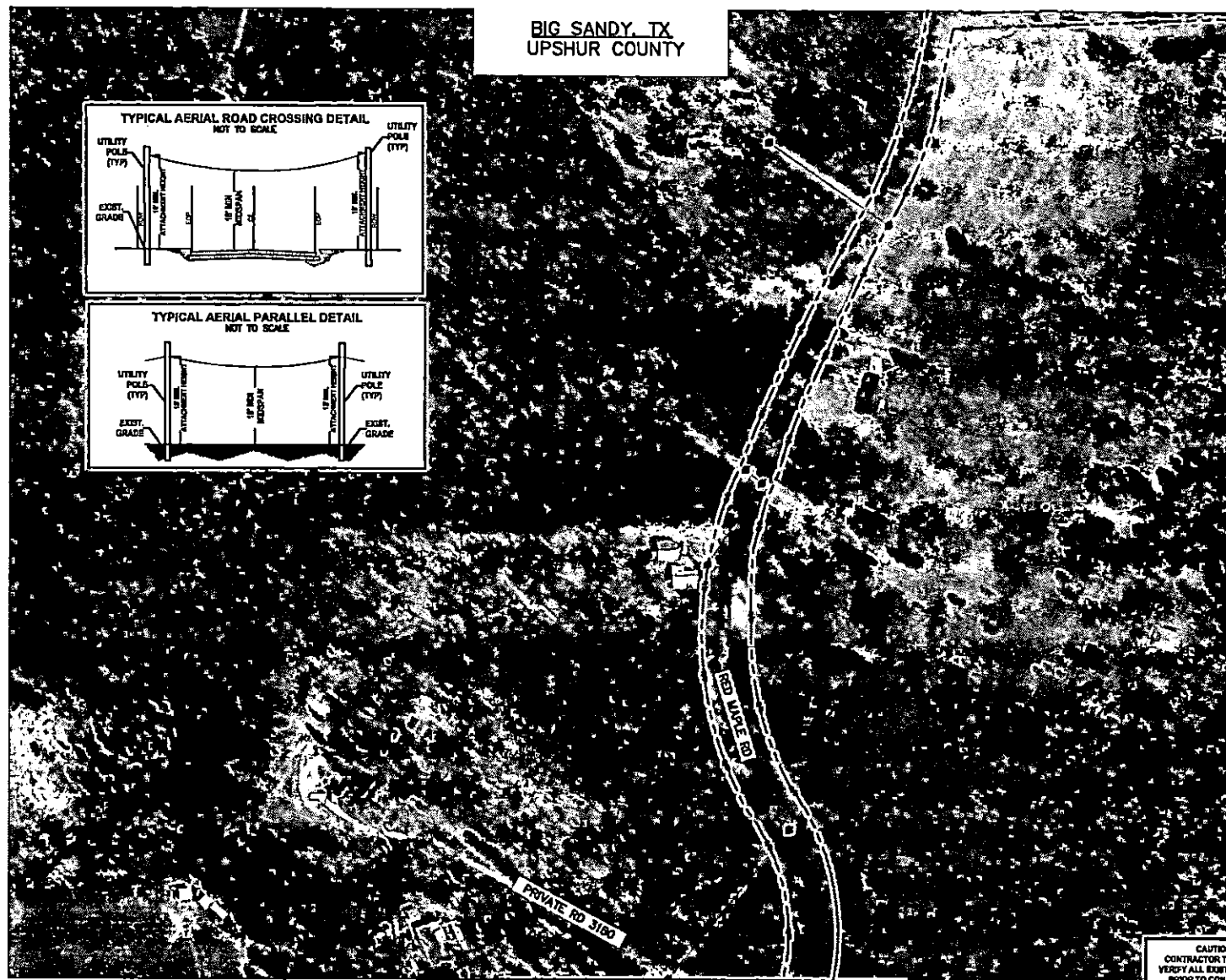
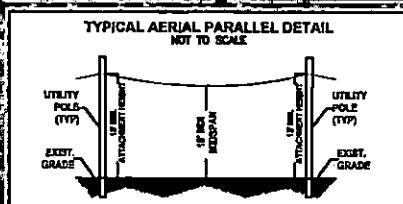
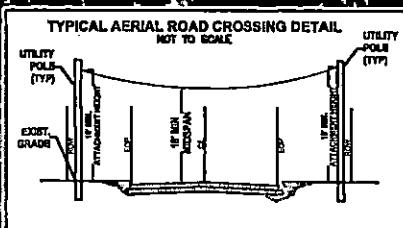

100 200 0 100 200
HORIZONTAL SCALE: 1" = 200'

- LEGEND
- PROF UNDERGROUND
 - PROF AERIAL
 - EX ROADWAY
 - EX R.O.W.
 - FENCE LINE
 - ROW AND FENCE LINE
 - EX WATER LINE
 - EX WASTEWATER LINE
 - EX STORM SEWER
 - EX DITCH LINE
 - EX ELECTRIC
 - EX GAS
 - EX TELECOM
 - PROF. 24" X 30" X 24" VAULT
 - PROF. 17" X 30" X 24" PED
 - EXISTING POLE
 - POLE W/ RISER
 - PROF ANCHOR

NOTE:
CONTRACTOR IS RESPONSIBLE TO MAINTAIN TRAFFIC CONTROL AS SET FORTH IN THE TEXAS MANUAL ON UNIFORM TRAFFIC CONTROL DEVICES FOR STREET AND HIGHWAYS.

NOTE:
UNDERGROUND UTILITIES HAVE BEEN PLOTTED FROM AVAILABLE RECORDS AND FIELD OBSERVATIONS BUT ARE NOT NECESSARILY EXACT. IT IS THE CONTRACTOR RESPONSIBILITY TO FIELD LOCATE ALL UNDERGROUND OBSTRUCTIONS AND UTILITIES PRIOR TO CONSTRUCTION. COMPLETE REPAIR OF ANY AND ALL DAMAGES INCURRED SHALL BE AT THE EXPENSE OF THE CONTRACTOR.

CAUTION!!
EXIST. BURIED FIBER, TELEPHONE, CATV, GAS, ELECTRIC, WATER, SANITARY SEWER & STORM SEWER FACILITIES IN CONSTRUCTION AREA AND HAVE NOT BEEN FIELD LOCATED. CONTRACTOR TO VERIFY EXACT LOCATION AND DEPTH PRIOR TO ANY DIGGING AND/OR BORING.

NOTE: THE RIGHT-OF-WAY (ROW) SHOWN ON THESE PLANS IS BASED ON PUBLICLY AVAILABLE INFORMATION AND IS NOT EXACT. IT IS THE CONTRACTOR'S RESPONSIBILITY FOR ENSURING THAT ALL FACILITIES ARE CONSTRUCTED WITHIN THE ROW OR IN A COMMUNICATIONS EASEMENT. THE CONTRACTOR SHALL NOTIFY THE ENGINEER AND THE OWNER PRIOR TO CONSTRUCTION IF THERE ARE ANY CONCERNS REGARDING THE ROW.



Spectrum

LJA
LJA TELECOM

SPECTRUM
3993829
RD05_TX_CLUSTER_2_TBD_WI56E
UPSHUR COUNTY
OSP PLAN

DESIGN BY: LJA	CHECKED BY: JL
DRAWN BY: RC	APPROVED BY: RB
PROJECT NO: 2605-24-N132	SHEET: 04 OF 29
DATE: 12/11/2024	PAGE: D4

CAUTION!!!
CONTRACTOR TO LOCATE & VERIFY ALL EXISTING UTILITIES PRIOR TO CONSTRUCTION

MATCHLINE - SEE SHEET 5

CAUTION III
CONTRACTOR TO LOCATE &
VERIFY ALL EXISTING UTILITIES
PRIOR TO CONSTRUCTION

12/11/2024 2:28:21 PM S:\Utility\Telecom\UPSHUR\PROJECTS\CHARTER-SPECTRUM\WORTH\TX\2803-24-N132\ROOF_TX_CLUSTER_2.TBD_WI56E\UPSHUR_County.dwg

BIG SANDY, TX
UPSHUR COUNTY

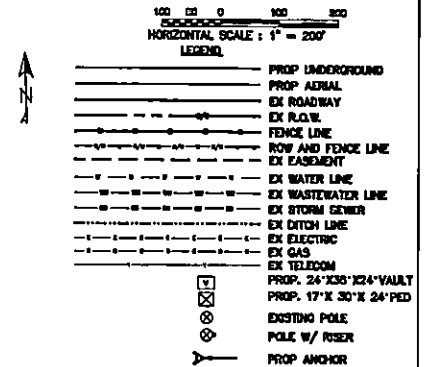
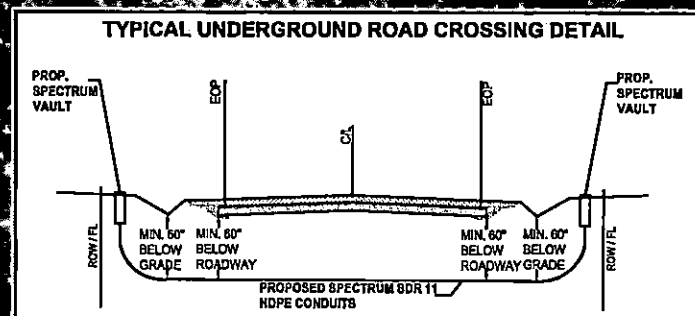
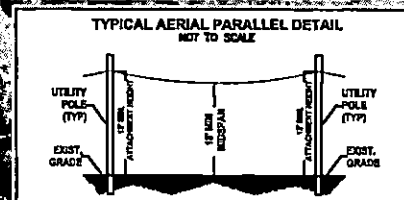
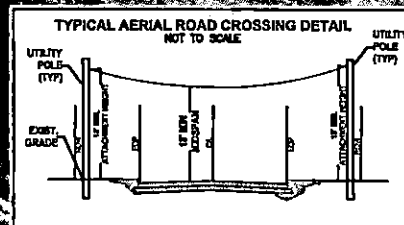
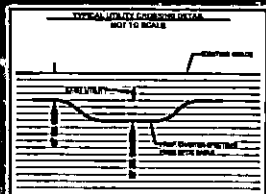
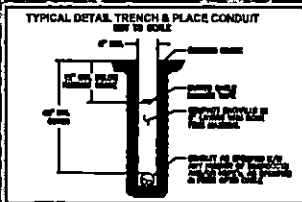

NOTE:
CONTRACTOR IS RESPONSIBLE TO MAINTAIN TRAFFIC CONTROL AS SET FORTH IN THE TEXAS MANUAL ON UNIFORM TRAFFIC CONTROL DEVICES FOR STREET AND HIGHWAYS.

NOTE:
UNDERGROUND UTILITIES HAVE BEEN PLOTTED FROM AVAILABLE RECORDS AND FIELD OBSERVATIONS BUT ARE NOT NECESSARILY EXACT. IT IS THE CONTRACTOR RESPONSIBILITY TO FIELD LOCATE ALL UNDERGROUND OBSTRUCTIONS AND UTILITIES PRIOR TO CONSTRUCTION. COMPLETE REPAIR OF ANY AND ALL DAMAGES INCURRED SHALL BE AT THE EXPENSE OF THE CONTRACTOR.

CAUTION!!
EXIST. BURIED FIBER, TELEPHONE, CATV, GAS, ELECTRIC, WATER, SANITARY SEWER & STORM SEWER FACILITIES IN CONSTRUCTION AREA AND HAVE NOT BEEN FIELD LOCATED. CONTRACTOR TO VERIFY EXACT LOCATION AND DEPTH PRIOR TO ANY DIGGING AND/OR BORING.

NOTE: THE RIGHT-OF-WAY (ROW) SHOWN ON THESE PLANS IS BASED ON PUBLICLY AVAILABLE INFORMATION AND IS NOT EXACT. IT IS THE CONTRACTOR'S RESPONSIBILITY FOR ENSURING THAT ALL FACILITIES ARE CONSTRUCTED WITHIN THE ROW OR IN A COMMUNICATIONS EASEMENT. THE CONTRACTOR SHALL NOTIFY THE ENGINEER AND THE OWNER PRIOR TO CONSTRUCTION IF THERE ARE ANY CONCERNS REGARDING THE ROW.



Spectrum

LJA
LJA TELECOM

SPECTRUM
3993829
ROOF_TX_CLUSTER_2.TBD_WI56E
UPSHUR COUNTY
OSP PLAN

DESIGN BY: LJA	CHECKED BY: J
DRAWN BY: RC	APPROVED BY: KB
PROJECT NO: 2803-24-N132	SHEET: 07 OF 29
DATE: 12/11/2024	PAGE: 07

CAUTION!!
CONTRACTOR TO LOCATE & VERIFY ALL EXISTING UTILITIES PRIOR TO CONSTRUCTION

MATCHLINE - SEE SHEET 8

12/11/2024 2:26:01 PM S:\Projects\2603-24-N132\PROJECTS\CHARTER-SPECTRUM\NORTH TEXAS\2603-24-N132\ROADS\TX_CLUSTER_2.TBD_WI56E\UPSHUR COUNTY\DWG 0903052603-24-N132.DWG

BIG SANDY, TX
UPSHUR COUNTY

MATCHLINE - SEE SHEET 7

TYPICAL UNDERGROUND ROAD CROSSING DETAIL

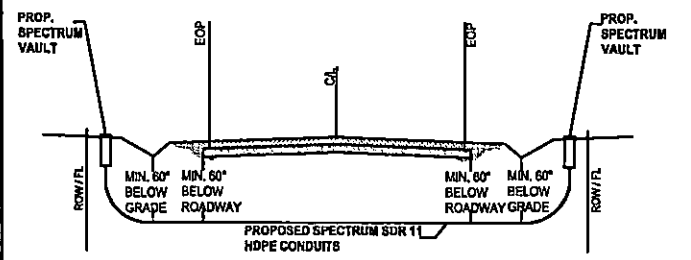

TYPICAL AERIAL ROAD CROSSING DETAIL
NOT TO SCALE

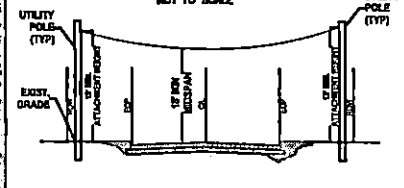

TYPICAL AERIAL PARALLEL DETAIL
NOT TO SCALE

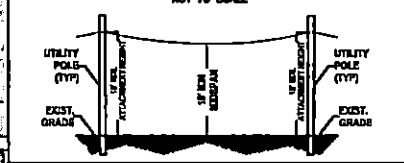

TYPICAL DETAIL TRENCH & PLACE CONDUIT
NOT TO SCALE

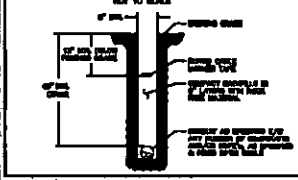

TYPICAL AERIAL CROSSING TO DETAIL
NOT TO SCALE

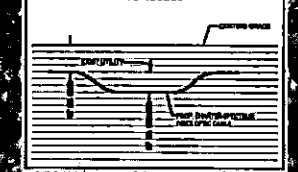

100 0 100 200
HORIZONTAL SCALE: 1" = 200'

LEGEND

- PROP. UNDERGROUND
- PROP. AERIAL
- EX. ROADWAY
- EX. FLOW
- FENCE LINE
- ROW AND FENCE LINE
- EX. EASEMENT
- EX. WATER LINE
- EX. WASTEWATER LINE
- EX. STORM SEWER
- EX. DITCH LINE
- EX. ELECTRIC
- EX. GAS
- EX. TELECOM
- PROP. 24" X 36" X 24" VAULT
- PROP. 17" X 30" X 24" VAULT
- EXISTING POLE
- POLE W/ RISER
- PROP. ANCHOR

NOTE:
CONTRACTOR IS RESPONSIBLE TO MAINTAIN TRAFFIC CONTROL AS SET FORTH IN THE TEXAS MANUAL ON UNIFORM TRAFFIC CONTROL DEVICES FOR STREET AND HIGHWAYS.

NOTE:
UNDERGROUND UTILITIES HAVE BEEN PLOTTED FROM AVAILABLE RECORDS AND FIELD OBSERVATIONS BUT ARE NOT NECESSARILY EXACT. IT IS THE CONTRACTOR'S RESPONSIBILITY TO FIELD LOCATE ALL UNDERGROUND OBSTRUCTIONS AND UTILITIES PRIOR TO CONSTRUCTION. COMPLETE REPAIR OF ANY AND ALL DAMAGES INCURRED SHALL BE AT THE EXPENSE OF THE CONTRACTOR.

CAUTION:
EXIST. BURIED FIBER, TELEPHONE, CATV, GAS, ELECTRIC, WATER, SANITARY SEWER & STORM SEWER FACILITIES IN CONSTRUCTION AREA AND HAVE NOT BEEN FIELD LOCATED. CONTRACTOR TO VERIFY EXACT LOCATION AND DEPTH PRIOR TO ANY DIGGING AND/OR BORING.

NOTE: THE RIGHT-OF-WAY (ROW) SHOWN ON THESE PLANS IS BASED ON PUBLICLY AVAILABLE INFORMATION AND IS NOT EXACT. IT IS THE CONTRACTOR'S RESPONSIBILITY FOR ENSURING THAT ALL FACILITIES ARE CONSTRUCTED WITHIN THE ROW OR IN A COMMUNICATIONS EASEMENT. THE CONTRACTOR SHALL NOTIFY THE ENGINEER AND THE OWNER PRIOR TO CONSTRUCTION IF THERE ARE ANY CONCERNS REGARDING THE ROW.



Spectrum



SPECTRUM
3993829
RDOF_TX_CLUSTER_2.TBD_WI56E
UPSHUR COUNTY
OSP PLAN

DESIGN BY:	LJA	CHECKED BY:	JL
DRAWN BY:	RC	APPROVED BY:	KB
PROJECT NO:	2603-24-N132	SHEET:	08 OF 29
DATE:	12/11/2024	PAGE:	08

CAUTION !!!
CONTRACTOR TO LOCATE & VERIFY ALL EXISTING UTILITIES PRIOR TO CONSTRUCTION

MATCHLINE - SEE SHEET 9

12/11/2024
2:28:01 PM
C:\Users\j\OneDrive\Documents\PROJECTS\UPSHUR COUNTY\2803-24-N132\2803-24-N132.TBD_W156E\UPSHUR COUNTY\UPSHUR COUNTY.dwg

BIG SANDY, TX
UPSHUR COUNTY

MATCHLINE - SEE SHEET 8

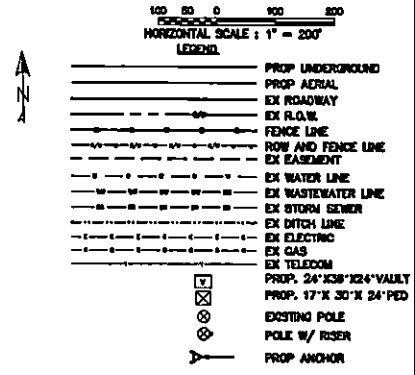
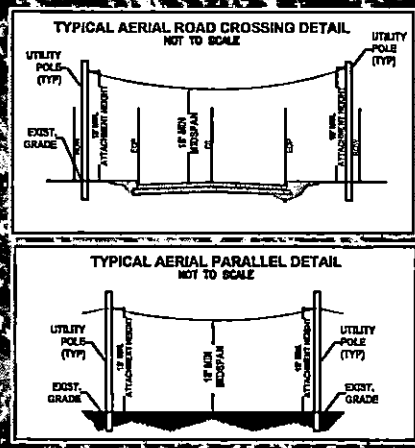
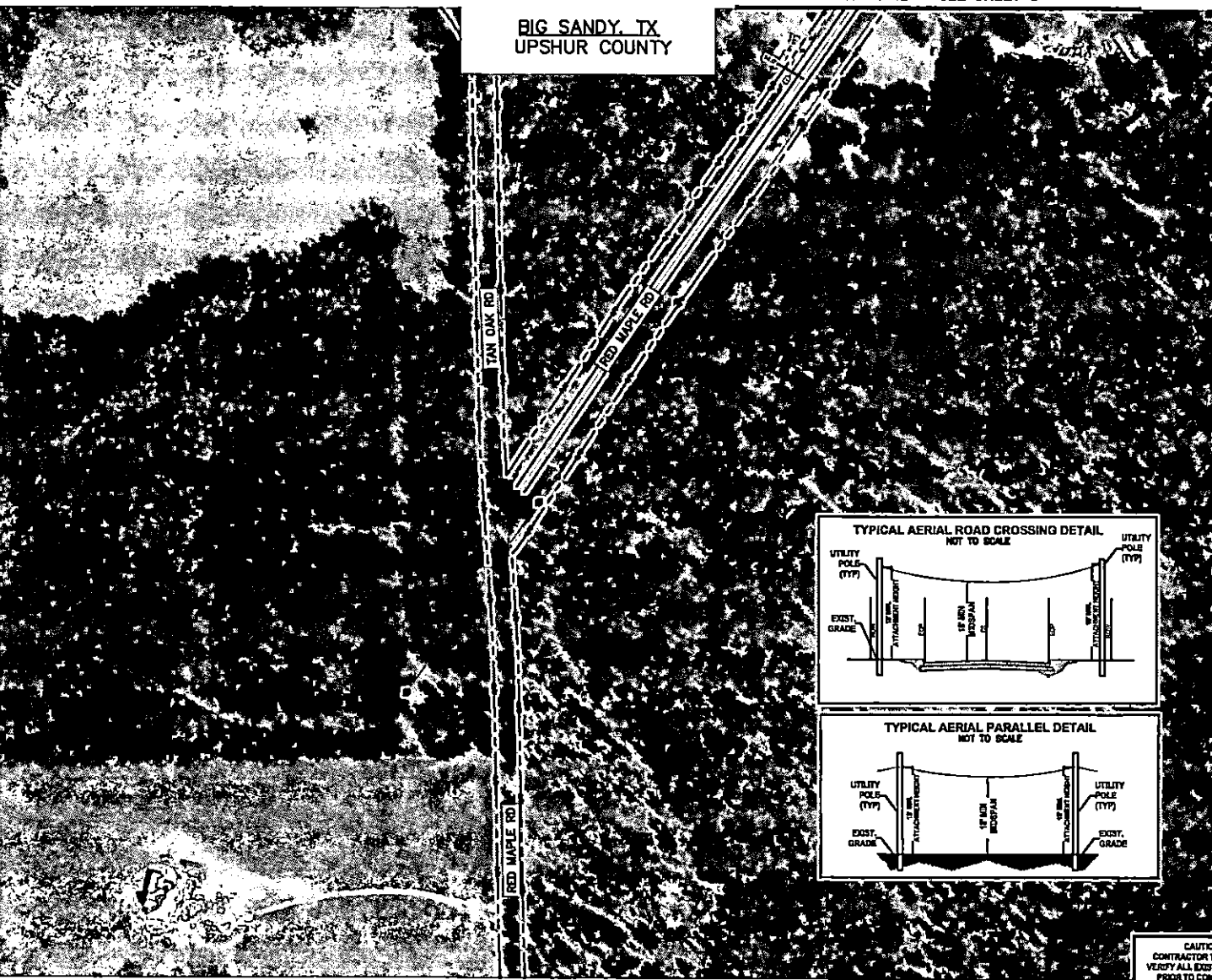

NOTE:
CONTRACTOR IS RESPONSIBLE TO MAINTAIN TRAFFIC CONTROL AS SET FORTH IN THE TEXAS MANUAL ON UNIFORM TRAFFIC CONTROL DEVICES FOR STREET AND HIGHWAY.

NOTE:
UNDERGROUND UTILITIES HAVE BEEN PLOTTED FROM AVAILABLE RECORDS AND FIELD OBSERVATIONS BUT ARE NOT NECESSARILY EXACT. IT IS THE CONTRACTOR RESPONSIBILITY TO FIELD LOCATE ALL UNDERGROUND OBSTRUCTIONS AND UTILITIES PRIOR TO CONSTRUCTION. COMPLETE REPAIR OF ANY AND ALL DAMAGES INCURRED SHALL BE AT THE EXPENSE OF THE CONTRACTOR.

CAUTION!!
EXIST. BURIED FIBER, TELEPHONE, CATV, GAS, ELECTRIC, WATER, SANITARY SEWER & STORM SEWER FACILITIES IN CONSTRUCTION AREA AND HAVE NOT BEEN FIELD LOCATED. CONTRACTOR TO VERIFY EXACT LOCATION AND DEPTH PRIOR TO ANY DIGGING AND/OR BORING.

NOTE: THE RIGHT-OF-WAY (ROW) SHOWN ON THESE PLANS IS BASED ON PUBLICLY AVAILABLE INFORMATION AND IS NOT EXACT. IT IS THE CONTRACTOR'S RESPONSIBILITY FOR ENSURING THAT ALL FACILITIES ARE CONSTRUCTED WITHIN THE ROW OR IN A COMMUNICATIONS EASEMENT. THE CONTRACTOR SHALL NOTIFY THE ENGINEER AND THE OWNER PRIOR TO CONSTRUCTION IF THERE ARE ANY CONCERNS REGARDING THE ROW.



Spectrum

LJA
LJA TELECOM

SPECTRUM
3993829
ROOF_TX_CLUSTER_2.TBD_W156E
UPSHUR COUNTY
OSP PLAN

DESIGN BY: LJA	CHECKED BY: JL
DRAWN BY: RC	APPROVED BY: KB
PROJECT NO: 2803-24-N132	SHEET: 09 OF 29
DATE: 12/11/2024	PAGE: 09

CAUTION!!!
CONTRACTOR TO LOCATE & VERIFY ALL EXISTING UTILITIES PRIOR TO CONSTRUCTION

BIG SANDY, TX
UPSHUR COUNTY

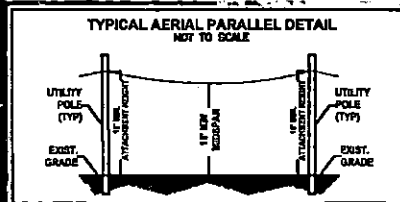
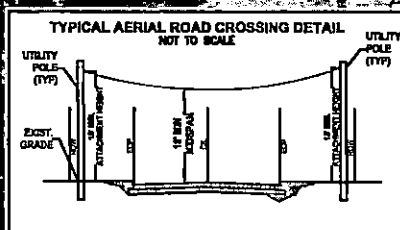

MATCHLINE - SEE SHEET 11

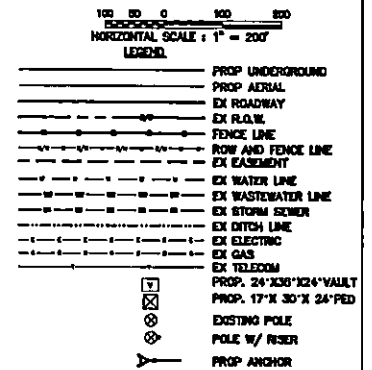

NOTE:
CONTRACTOR IS RESPONSIBLE TO MAINTAIN TRAFFIC CONTROL AS SET FORTH IN THE TEXAS MANUAL ON UNIFORM TRAFFIC CONTROL DEVICES FOR STREET AND HIGHWAYS.

NOTE:
UNDERGROUND UTILITIES HAVE BEEN PLOTTED FROM AVAILABLE RECORDS AND FIELD OBSERVATIONS BUT ARE NOT NECESSARILY EXACT. IT IS THE CONTRACTOR RESPONSIBILITY TO FIELD LOCATE ALL UNDERGROUND OBSTRUCTIONS AND UTILITIES PRIOR TO CONSTRUCTION. COMPLETE REPAIR OF ANY AND ALL DAMAGES INCURRED SHALL BE AT THE EXPENSE OF THE CONTRACTOR.

CAUTION!
EXIST. BURIED FIBER, TELEPHONE, CATV, GAS, ELECTRIC,
WATER, SANITARY SEWER & STORM SEWER FACILITIES ON
CONSTRUCTION AREA AND HAVE NOT BEEN FIELD LOCATED.
CONTRACTOR TO VERIFY EXACT LOCATION AND DEPTH
PRIOR TO ANY DIGGING AND/OR BORING.

NOTE: THE RIGHT-OF-WAY (ROW) SHOWN ON THESE PLANS IS BASED ON PUBLICLY AVAILABLE INFORMATION AND IS NOT EXACT. IT IS THE CONTRACTOR'S RESPONSIBILITY FOR ENSURING THAT ALL FACILITIES ARE CONSTRUCTED WITHIN THE ROW OR IN A COMMUNICATIONS EASEMENT. THE CONTRACTOR SHALL NOTIFY THE ENGINEER AND THE OWNER PRIOR TO CONSTRUCTION IF THERE ARE ANY CONCERNS REGARDING THE ROW.



Spectrum▶

LJA
LJA TELECOM

SPECTRUM
3993829
RDOF_TX_CLUSTER_2_TBD_WI56E
UPSHUR COUNTY
OSP PLAN

DESIGN BY: LJAT	CHECKED BY: JL
DRAWN BY: RC	APPROVED BY: KB
PROJECT NO: 2605-24-NJ32	SHEET: 10 OF 29
DATE: 12/11/2024	PAGE: 10

**CAUTION !!!
CONTRACTOR TO LOCATE &
VERIFY ALL EXISTING UTILITIES
PRIOR TO CONSTRUCTION**

STREET NAME

ME

2

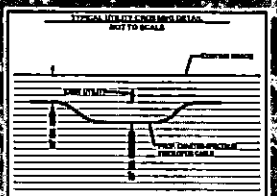
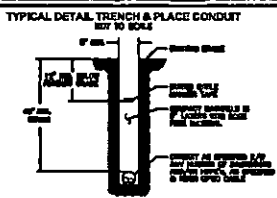

TYPICAL UNDERGROUND ROAD CROSSING DETAIL

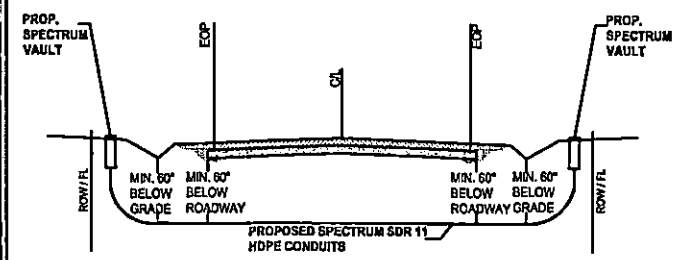

TYPICAL AERIAL ROAD CROSSING DETAIL
NOT TO SCALE

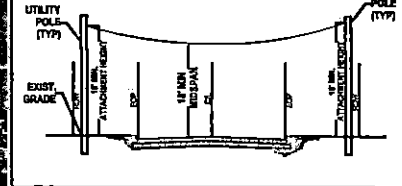

TYPICAL AERIAL PARALLEL DETAIL
NOT TO SCALE

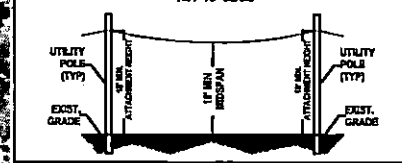

**CAUTION !!!
CONTRACTOR TO LOCATE &
VERIFY ALL EXISTING UTILITIES
PRIOR TO CONSTRUCTION**



LEGEND:

-
- PROP UNDERGROUND
 PROP AERIAL
 EX ROADWAY
 EX R.O.W.
 FENCE LINE
 ROW AND Easement LINE
 EX EASEMENT
 EX WATER LINE
 EX WASTEWATER LINE
 EX STORAGE TANKER
 EX DITCH LINE
 EX ELECTRIC
 EX GAS
 EX TELECOM
 PROP. 24'x36'x124' VAULT
 PROP. 17'x 30'x 24' PED
 DOSTING POLE
 POLE w/ RISER
 PROP ANCHOR

NOTE:
CONTRACTOR IS RESPONSIBLE TO MAINTAIN TRAFFIC
CONTROL AS SET FORTH IN THE TEXAS MANUAL ON
UNIFORM TRAFFIC CONTROL DEVICES FOR STREET AND
HIGHWAYS.

NOTE:
UNDERGROUND UTILITIES HAVE BEEN PLOTTED FROM AVAILABLE RECORDS AND FIELD OBSERVATIONS BUT ARE NOT NECESSARILY EXACT. IT IS THE CONTRACTOR RESPONSIBILITY TO FIELD LOCATE ALL UNDERGROUND OBSTRUCTIONS AND UTILITIES PRIOR TO CONSTRUCTION. COMPLETE REPAIR OF ANY AND ALL DAMAGES INCURRED SHALL BE AT THE EXPENSE OF THE CONTRACTOR.

CAUTION!!!
EXIST. DURED FIBER, TELEPHONE, CATV, GAS, ELECTRIC,
WATER, SANITARY SEWER & STORM SEWER FACILITIES IN
CONSTRUCTION AREA AND HAVE NOT BEEN FIELD LOCATED.
CONTRACTOR TO VERIFY EXACT LOCATION AND DEPTH
PRIOR TO ANY DREDGING AND/OR DREDGING.

NOTE: THE RIGHT-OF-WAY (ROW) SHOWN ON THESE PLANS IS BASED ON PUBLICLY AVAILABLE INFORMATION AND IS NOT EXACT. IT IS THE CONTRACTOR'S RESPONSIBILITY FOR ENSURING THAT ALL FACILITIES ARE CONSTRUCTED WITHIN THE ROW OR IN A COMMUNICATIONS EASEMENT. THE CONTRACTOR SHALL NOTIFY THE ENGINEER AND THE OWNER PRIOR TO CONSTRUCTION IF THERE ARE ANY CONCERNS REGARDING THE ROW.

**Spectrum▶**

LJA
LJA TELECOM

SPECTRUM
3993829
RDOF_TX_CLUSTER_2_TBD_WI56E
UPSHUR COUNTY
QSP PLAN

DESIGN BY: LJAT	CHECKED BY: JL
DRAWN BY: RC	APPROVED BY: KB
PROJECT NO: 2605-24-N132	SHEET: 11 OF 29
DATE: 12/11/2024	PAGE: 11

12/11/2024 2:28:50 PM S:\Customer\1\mccoy\01\BIDD PROJECT\COMMENTS-SPEC\TRANSDATA\TX\2605-24-4132 RDOP_TX_CLUSTER_2.TBD_W156E UPSHUR COUNTY.dwg

BIG SANDY, TX
UPSHUR COUNTY

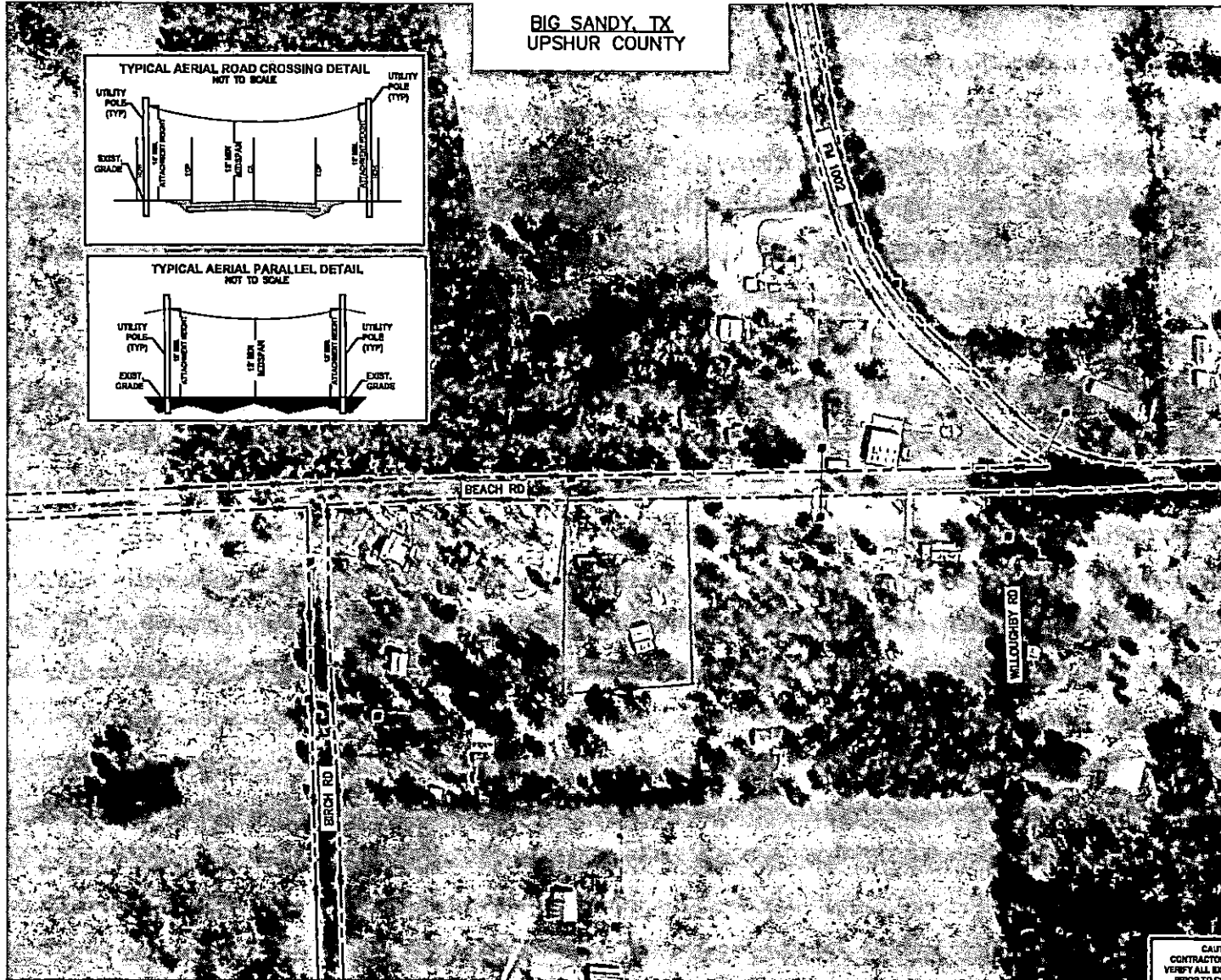
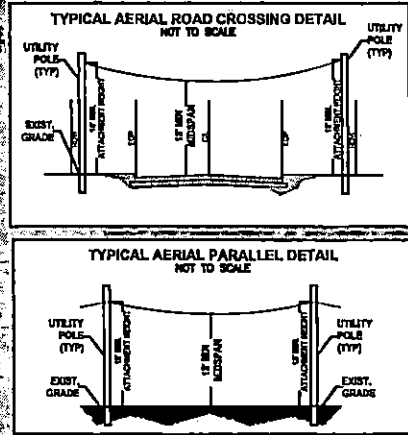

100 50 0 50 100 200
HORIZONTAL SCALE: 1" = 200'

LEGEND

---	PROP. UNDERGROUND
---	PROP. ADRIAL
---	EX. ROADWAY
---	EX. R.O.W.
---	FENCE LINE
---	ROW AND FENCE LINE
---	EX. EASEMENT
---	EX. WATER LINE
---	EX. WASTEWATER LINE
---	EX. STORM SEWER
---	EX. DITCH LINE
---	EX. ELECTRIC
---	EX. GAS
---	EX. TELECOM
---	PROP. 24" X36" X24" VAULT
---	PROP. 17" X 30" X 24" PED
---	EXISTING POLE
---	POLE W/ RISER
---	PROP. ANCHOR

NOTE:
CONTRACTOR IS RESPONSIBLE TO MAINTAIN TRAFFIC CONTROL AS SET FORTH IN THE TEXAS MANUAL ON UNIFORM TRAFFIC CONTROL DEVICES FOR STREET AND HIGHWAYS.

NOTE:
UNDERGROUND UTILITIES HAVE BEEN PLOTTED FROM AVAILABLE RECORDS AND FIELD OBSERVATIONS BUT ARE NOT NECESSARILY EXACT. IT IS THE CONTRACTOR RESPONSIBILITY TO FIELD LOCATE ALL UNDERGROUND OBSTRUCTIONS AND UTILITIES PRIOR TO CONSTRUCTION. COMPLETE REPAIR OF ANY AND ALL DAMAGES INCURRED SHALL BE AT THE EXPENSE OF THE CONTRACTOR.

CAUTION!
EXIST. BURIED FIBER, TELEPHONE, CATV, GAS, ELECTRIC, WATER, SANITARY SEWER & STORM SEWER FACILITIES IN CONSTRUCTION AREA AND HAVE NOT BEEN FIELD LOCATED. CONTRACTOR TO VERIFY EXACT LOCATION AND DEPTH PRIOR TO ANY DIGGING AND/OR BORING.

NOTE: THE RIGHT-OF-WAY (ROW) SHOWN ON THESE PLANS IS BASED ON PUBLICLY AVAILABLE INFORMATION AND IS NOT EXACT. IT IS THE CONTRACTOR'S RESPONSIBILITY FOR ENSURING THAT ALL FACILITIES ARE CONSTRUCTED WITHIN THE ROW OR IN A COMMUNICATIONS EASEMENT. THE CONTRACTOR SHALL NOTIFY THE ENGINEER AND THE OWNER PRIOR TO CONSTRUCTION IF THERE ARE ANY CONCERNS REGARDING THE ROW.



Spectrum

LJA
LJA TELECOM

SPECTRUM
3993829
RDOP_TX_CLUSTER_2.TBD_W156E
UPSHUR COUNTY
OSP PLAN

DESIGN BY: LJA	CHECKED BY: JL
DRAWN BY: RC	APPROVED BY: KB
PROJECT NO: 2605-24-4132	SHEET 12 OF 29
DATE: 12/11/2024	PAGE: 12

CAUTION !!!
CONTRACTOR TO LOCATE &
VERIFY ALL EXISTING UTILITIES
PRIOR TO CONSTRUCTION

**BIG SANDY, TX
UPSHUR COUNTY**

**TYPICAL AERIAL ROAD CROSSING DETAIL
NOT TO SCALE**

UTILITY POLE (TYP)
EXIST. GRADE
ATTACHMENT POINT
12' MIN. SPAN
12' MIN. SPAN
ATTACHMENT POINT
UTILITY POLE (TYP)

**TYPICAL AERIAL PARALLEL DETAIL
NOT TO SCALE**

UTILITY POLE (TYP)
EXIST. GRADE
ATTACHMENT POINT
12' MIN. SPAN
12' MIN. SPAN
ATTACHMENT POINT
UTILITY POLE (TYP)
EXIST. GRADE

RED MAPLE RD

CAUTION
CONTRACTOR
VERIFY ALL EX

100 0 100 200
HORIZONTAL SCALE: 1" = 200'

LEGEND

	PROP UNDERGROUND
	PROP AERIAL
	EX ROADWAY
	EX R.O.W.
	FENCE LINE
	SHOW AND HIDE LINE
	EX EASEMENT
	EX WATER LINE
	EX WASTEWATER LINE
	EX STORM SEWER
	EX DITCH LINE
	EX ELECTRIC
	EX GAS
	EX TELECOM
	PROP. 24"x30"x24" VALVE
	PROP. 17"x 30"x 24" P.D.
	EXISTING POLE
	POLE W/ RISER
	PROP ANCHOR

NOTE:
CONTRACTOR IS RESPONSIBLE TO MAINTAIN TRAFFIC
CONTROL AS SET FORTH IN THE TEXAS MANUAL ON
UNIFORM TRAFFIC CONTROL DEVICES FOR STREET AND
HIGHWAYS.

NOTE:
UNDERGROUND UTILITIES HAVE BEEN PLOTTED FROM AVAILABLE RECORDS AND FIELD OBSERVATIONS BUT ARE NOT NECESSARILY EXACT. IT IS THE CONTRACTOR RESPONSIBILITY TO FIELD LOCATE ALL UNDERGROUND OBSTRUCTIONS AND UTILITIES PRIOR TO CONSTRUCTION. COMPLETE REPAIR OF ANY AND ALL DAMAGES INCURRED SHALL BE AT THE EXPENSE OF THE CONTRACTOR.

CAUTION!!
EXST. BURIED FIBER, TELEPHONE, CATV, GAS, ELECTRIC,
WATER, SANITARY SEWER & STORM SEWER FACILITIES IN
CONSTRUCTION AREA AND HAVE NOT BEEN FIELD LOCATED.
CONTRACTOR TO VERIFY EXACT LOCATION AND DEPTH
PRIOR TO ANY DIGGING AND/OR BORING.

NOTE: THE RIGHT-OF-WAY (ROW) SHOWN ON THESE PLANS IS BASED ON PUBLICLY AVAILABLE INFORMATION AND IS NOT EXACT. IT IS THE CONTRACTOR'S RESPONSIBILITY FOR ENSURING THAT ALL FACILITIES ARE CONSTRUCTED WITHIN THE ROW OR IN A COMMUNICATIONS EASEMENT. THE CONTRACTOR SHALL NOTIFY THE ENGINEER AND THE OWNER PRIOR TO CONSTRUCTION IF THERE ARE ANY CONCERNS REGARDING THE ROW.



Spectrum

LJA
LJA TELECOM

SPECTRUM
3993829
RDOF_TX_CLUSTER_2_TBD_WI56E
UPSHUR COUNTY
OSP PLAN

DESIGN BY: LJAT	CHECKED BY: JL
DRAWN BY: RC	APPROVED BY: KB
PROJECT NO: 2605-24-NJ32	SHEET: 13 OF 29
DATE: 12/11/2024	PAGE: 13

BIG SANDY, TX UPSHUR COUNTY

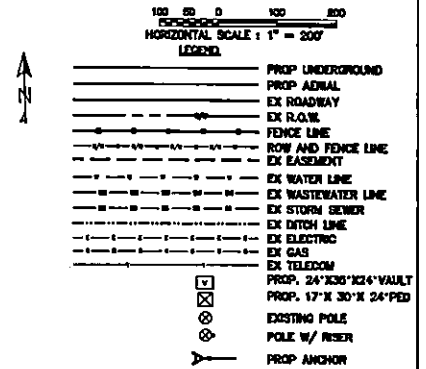
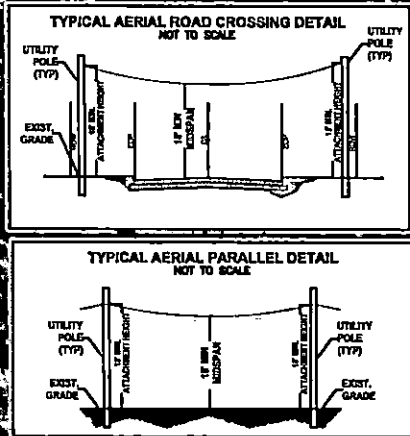

NOTE:
CONTRACTOR IS RESPONSIBLE TO MAINTAIN TRAFFIC CONTROL AS SET FORTH IN THE TEXAS MANUAL ON UNIFORM TRAFFIC CONTROL DEVICES FOR STREET AND HIGHWAYS.

NOTE:
UNDERGROUND UTILITIES HAVE BEEN PLOTTED FROM AVAILABLE RECORDS AND FIELD OBSERVATIONS BUT ARE NOT NECESSARILY EXACT. IT IS THE CONTRACTOR'S RESPONSIBILITY TO FIELD LOCATE ALL UNDERGROUND OBSTRUCTIONS AND UTILITIES PRIOR TO CONSTRUCTION. COMPLETE REPAIR OF ANY AND ALL DAMAGES INCURRED SHALL BE AT THE EXPENSE OF THE CONTRACTOR.

CAUTION!!
EXIST. BURIED FIBER, TELEPHONE, CATV, GAS, ELECTRIC, WATER, SANITARY SEWER & STORM SEWER FACILITIES IN CONSTRUCTION AREA AND HAVE NOT BEEN FIELD LOCATED. CONTRACTOR TO VERIFY EXACT LOCATION AND DEPTH PRIOR TO ANY DIGGING AND/OR BORING.

NOTE: THE RIGHT-OF-WAY (ROW) SHOWN ON THESE PLANS IS BASED ON PUBLICLY AVAILABLE INFORMATION AND IS NOT EXACT. IT IS THE CONTRACTOR'S RESPONSIBILITY FOR ENSURING THAT ALL FACILITIES ARE CONSTRUCTED WITHIN THE ROW OR IN A COMMUNICATIONS EASEMENT, THE CONTRACTOR SHALL NOTIFY THE ENGINEER AND THE OWNER PRIOR TO CONSTRUCTION IF THERE ARE ANY CONCERNS REGARDING THE ROW.



Spectrum

LJA
LJA TELECOM

SPECTRUM
3993829
RDOF_TX_CLUSTER_2_TBD_W5E
UPSHUR COUNTY
OSP PLAN

DESIGN BY: LJA	CHECKED BY: JL
DRAWN BY: RC	APPROVED BY: KB
PROJECT NO: 2605-24-N132	SHEET 14 OF 29
DATE: 12/11/2024	PAGE: 14

CAUTION !!!
CONTRACTOR TO LOCATE & VERIFY ALL EXISTING UTILITIES PRIOR TO CONSTRUCTION

MATCHLINE - SEE SHEET 15

12/11/2024 2:50 PM Spectrum Telecom - PROJECTS\CHARACTER - SPECTRUM\TX_CLUSTER_2_TBD_WI56E - RDOF_TX_CLUSTER_2_TBD_WI56E - 12/11/2024 2:50 PM

BIG SANDY, TX
UPSHUR COUNTY

MATCHLINE - SEE SHEET 15

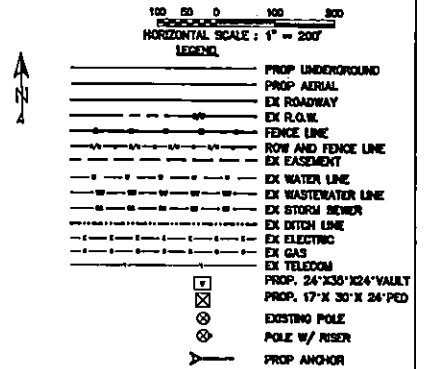
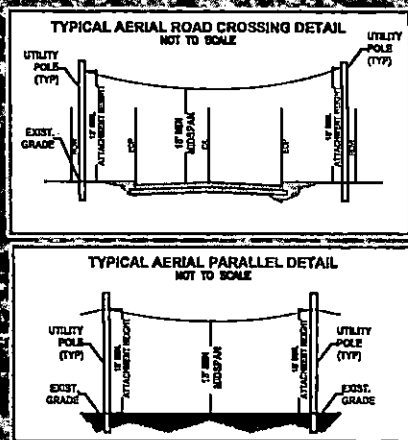

NOTE:
CONTRACTOR IS RESPONSIBLE TO MAINTAIN TRAFFIC CONTROL AS SET FORTH IN THE TEXAS MANUAL ON UNIFORM TRAFFIC CONTROL DEVICES FOR STREET AND HIGHWAYS.

NOTE:
UNDERGROUND UTILITIES HAVE BEEN PLOTTED FROM AVAILABLE RECORDS AND FIELD OBSERVATIONS BUT ARE NOT NECESSARILY EXACT. IT IS THE CONTRACTOR RESPONSIBILITY TO FIELD LOCATE ALL UNDERGROUND OBSTRUCTIONS AND UTILITIES PRIOR TO CONSTRUCTION. COMPLETE REPAIR OF ANY AND ALL DAMAGES INCURRED SHALL BE AT THE EXPENSE OF THE CONTRACTOR.

CAUTION!!
EXIST. BURIED FIBER, TELEPHONE, CATV, GAS, ELECTRIC, WATER, SANITARY SEWER & STORM SEWER FACILITIES IN CONSTRUCTION AREA AND HAVE NOT BEEN FIELD LOCATED. CONTRACTOR TO VERIFY EXACT LOCATION AND DEPTH PRIOR TO ANY DIGGING AND/OR BORING.

NOTE: THE RIGHT OF WAY (ROW) SHOWN ON THESE PLANS IS BASED ON PUBLICLY AVAILABLE INFORMATION AND IS NOT EXACT. IT IS THE CONTRACTOR'S RESPONSIBILITY FOR ENSURING THAT ALL FACILITIES ARE CONSTRUCTED WITHIN THE ROW OR IN A COMMUNICATIONS EASEMENT. THE CONTRACTOR SHALL NOTIFY THE ENGINEER AND THE OWNER PRIOR TO CONSTRUCTION IF THERE ARE ANY CONCERNS REGARDING THE ROW.



Spectrum

LJA
LJA TELECOM

SPECTRUM
3993829
RDOF_TX_CLUSTER_2_TBD_WI56E
UPSHUR COUNTY
OSP PLAN

DESIGN BY: LJA	CHECKED BY: J
DRAWN BY: RC	APPROVED BY: KB
PROJECT NO: 2605-24-N32	SHEET: 15 OF 29
DATE: 12/11/2024	PAGE: 15

CAUTION III:
CONTRACTOR TO LOCATE & VERIFY ALL EXISTING UTILITIES PRIOR TO CONSTRUCTION

**CAUTION (I)
CONTRACTOR TO LOCATE &
VERIFY ALL EXISTING UTILITIES
PRIOR TO CONSTRUCTION**





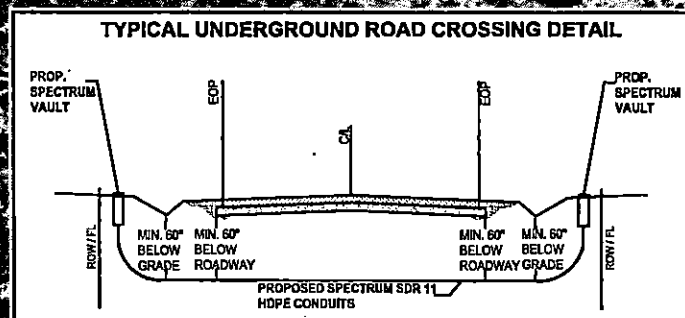
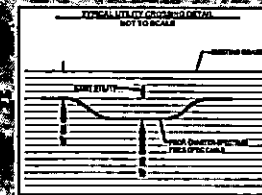
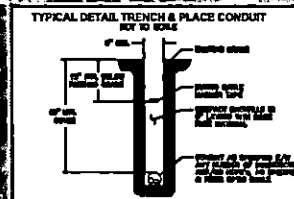
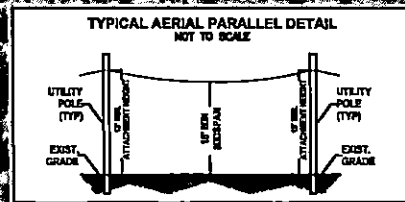
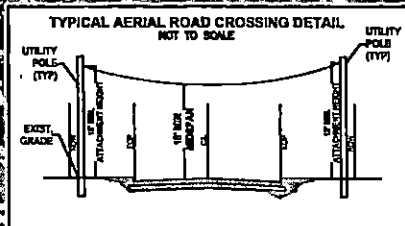



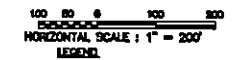









BIG SANDY, TX
UPSHUR COUNTY

MATCHLINE — SEE SHEET 19



**CAUTION !!!
CONTRACTOR TO LOCATE &
VERIFY ALL EXISTING UTILITIES
PRIOR TO CONSTRUCTION**



 PROP UNDERGROUND
 PROP ADRIAL
 EX ROADWAY
 EX R.O.M.
 FENCE LINE
 ROW AND FENCE LINE
 EX EASEMENT
 EX WATER LINE
 EX WASTEWATER LINE
 EX STORM SEWER
 EX DITCH LINE
 EX ELECTRIC
 EX GAS
 EX TELEDOM
 PROP. 24'x30'x24' VAULT
 PROP. 17'x 30'x 24' PED
 EXISTING POLE
 POLE W/ RISER
 PROP ANCHOR

NOTE:
CONTRACTOR IS RESPONSIBLE TO MAINTAIN TRAFFIC
CONTROL AS SET FORTH IN THE TEXAS MANUAL ON
UNIFORM TRAFFIC CONTROL DEVICES FOR STREET AND
HIGHWAYS.

NOTE:
UNDERGROUND UTILITIES HAVE BEEN PLOTTED FROM AVAILABLE RECORDS AND FIELD OBSERVATIONS BUT ARE NOT NECESSARILY EXACT. IT IS THE CONTRACTOR RESPONSIBILITY TO FIELD LOCATE ALL UNDERGROUND OBSTRUCTIONS AND UTILITIES PRIOR TO CONSTRUCTION. COMPLETE REPAIR OF ANY AND ALL DAMAGES INCURRED SHALL BE AT THE EXPENSE OF THE CONTRACTOR.

CAUTION:
EXIST. BURIED FIBER, TELEPHONE, CATV, GAS, ELECTRIC,
WATER, SANITARY SEWER & STORM SEWER FACILITIES IN
CONSTRUCTION AREA AND HAVE NOT BEEN FIELD LOCATED.
CONTRACTOR TO VERIFY EXACT LOCATION AND DEPTH
PRIOR TO ANY DIGGING AND/OR BORING.

NOTE: THE RIGHT-OF-WAY (ROW) SHOWN ON THESE PLANS IS BASED ON PUBLICLY AVAILABLE INFORMATION AND IS NOT EXACT. IT IS THE CONTRACTOR'S RESPONSIBILITY FOR ENSURING THAT ALL FACILITIES ARE CONSTRUCTED WITHIN THE ROW OR IN A CONVEYANCE EASEMENT. THE CONTRACTOR SHALL NOTIFY THE ENGINEER AND THE OWNER PRIOR TO CONSTRUCTION IF THERE ARE ANY CONCERNS REGARDING THE ROW.

**Spectrum**▶

LJA
LJA TELECOM

SPECTRUM
3993829
RDOF_TX_CLUSTER_2_TBD_WI56E
UPSHUR COUNTY
OSP PLAN

DESIGN BY: LJAT	CHECKED BY: JL
DRAWN BY: RC	APPROVED BY: KB
PROJECT NO: 2805-24-N132	SHEET: 18 OF 29
DATE: 12/11/2024	PAGE: 18

12/11/2024 2:26:01 PM S:\Users\j\Documents\PROJECTS\UPSHUR COUNTY\2805-24-1132\ROOF_TX_CLUSTER_2_TBD_WI56E\DESIGN\UPSHUR COUNTY\2805-24-1132\ROOF_TX_CLUSTER_2_TBD_WI56E\UPSHUR COUNTY.dwg

BIG SANDY, TX
UPSHUR COUNTY

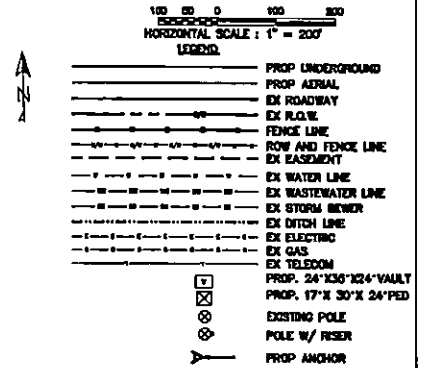
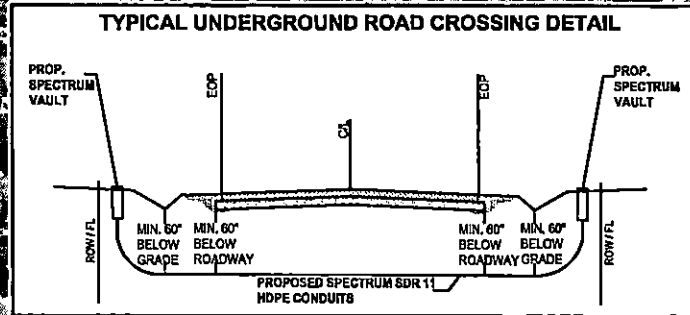
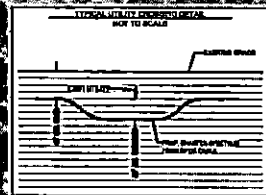
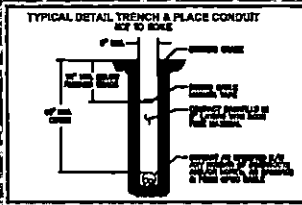

NOTE:
CONTRACTOR IS RESPONSIBLE TO MAINTAIN TRAFFIC CONTROL AS SET FORTH IN THE TEXAS MANUAL ON UNIFORM TRAFFIC CONTROL DEVICES FOR STREET AND HIGHWAYS.

NOTE:
UNDERGROUND UTILITIES HAVE BEEN PLOTTED FROM AVAILABLE RECORDS AND FIELD OBSERVATIONS BUT ARE NOT NECESSARILY EXACT. IT IS THE CONTRACTOR RESPONSIBILITY TO FIELD LOCATE ALL UNDERGROUND OBSTRUCTIONS AND UTILITIES PRIOR TO CONSTRUCTION. COMPLETE REPAIR OF ANY AND ALL DAMAGES INCURRED SHALL BE AT THE EXPENSE OF THE CONTRACTOR.

CAUTION!!!
EXIST. BURIED FIBER, TELEPHONE, CATV, GAS, ELECTRIC, WATER, SANITARY SEWER & STORM SEWER FACILITIES IN CONSTRUCTION AREA AND HAVE NOT BEEN FIELD LOCATED. CONTRACTOR TO VERIFY EXACT LOCATION AND DEPTH PRIOR TO ANY DIGGING AND/OR BORING.

NOTE: THE RIGHT-OF-WAY (ROW) SHOWN ON THESE PLANS IS BASED ON PUBLICLY AVAILABLE INFORMATION AND IS NOT EXACT. IT IS THE CONTRACTOR'S RESPONSIBILITY FOR ENSURING THAT ALL FACILITIES ARE CONSTRUCTED WITHIN THE ROW OR IN A COMMUNICATIONS EASEMENT. THE CONTRACTOR SHALL NOTIFY THE ENGINEER AND THE OWNER PRIOR TO CONSTRUCTION IF THERE ARE ANY CONCERNS REGARDING THE ROW.

MATCHLINE - SEE SHEET 20

MATCHLINE - SEE SHEET 18

CAUTION !!!
CONTRACTOR TO LOCATE & VERIFY ALL EXISTING UTILITIES PRIOR TO CONSTRUCTION



Spectrum

LJA
LJA TELECOM

SPECTRUM
3993829
ROOF_TX_CLUSTER_2_TBD_WI56E
UPSHUR COUNTY
OSP PLAN

DESIGN BY: LJA	CHECKED BY: JL
DRAWN BY: RC	APPROVED BY: KB
PROJECT NO: 2805-24-1132	SHEET 19 OF 29
DATE: 12/11/2024	PAGE: 19

MATCHLINE -- SEE SHEET 19

BIG SANDY, TX
UPSHUR COUNTY

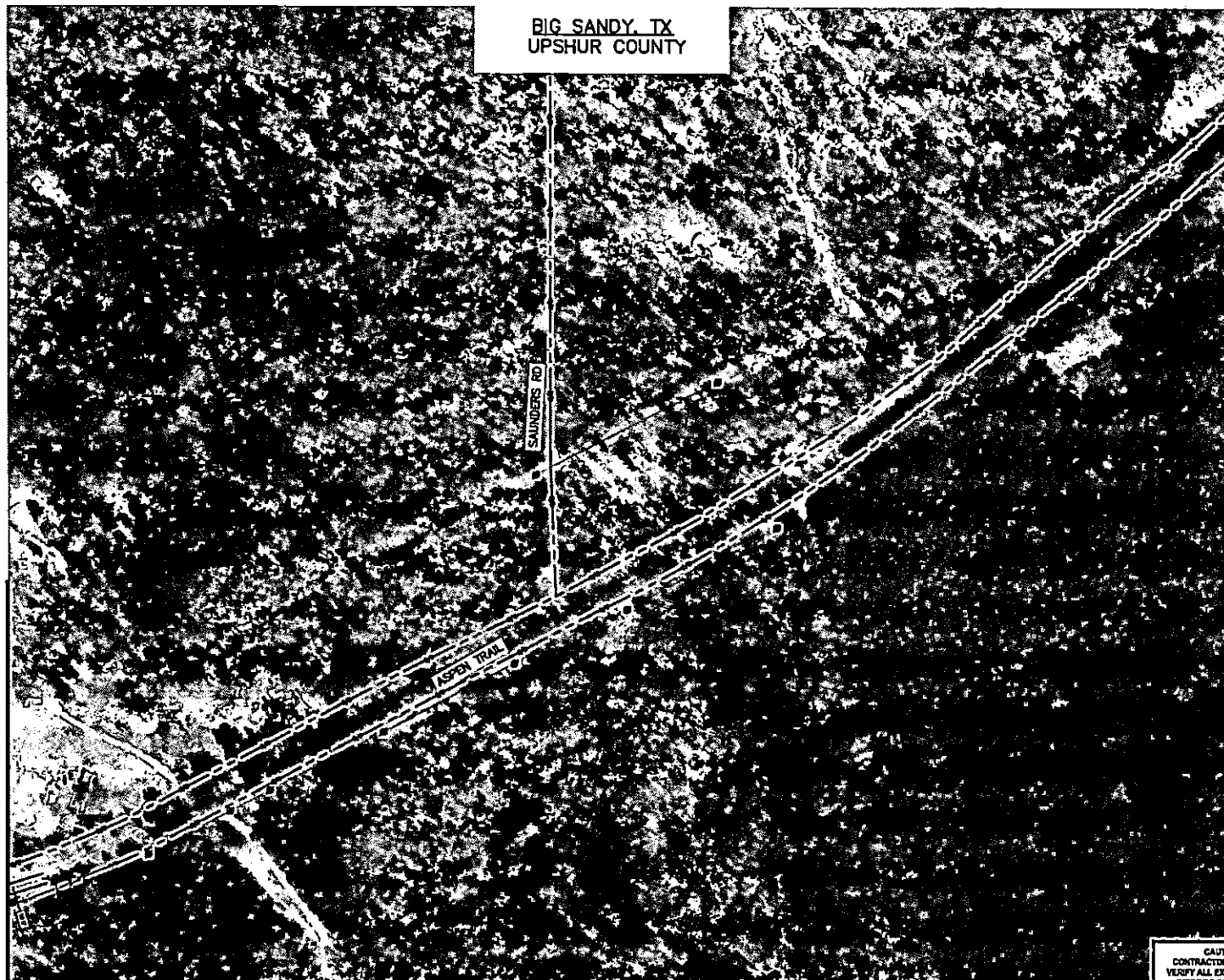

CAUTION !!!
CONTRACTOR TO LOCATE &
VERIFY ALL EXISTING UTILITIES
PRIOR TO CONSTRUCTION



LEGEND

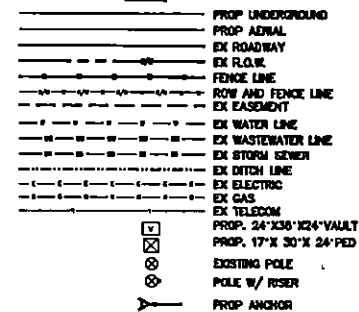

NOTE:
CONTRACTOR IS RESPONSIBLE TO MAINTAIN TRAFFIC CONTROL AS SET FORTH IN THE TEXAS MANUAL ON UNIFORM TRAFFIC CONTROL DEVICES FOR STREET AND HIGHWAYS.

NOTE:
UNDERGROUND UTILITIES HAVE BEEN PLOTTED FROM AVAILABLE RECORDS AND FIELD OBSERVATIONS BUT ARE NOT NECESSARILY EXACT. IT IS THE CONTRACTOR RESPONSIBILITY TO FIELD LOCATE ALL UNDERGROUND OBSTRUCTIONS AND UTILITIES PRIOR TO CONSTRUCTION. COMPLETE REPAIR OF ANY AND ALL DAMAGES INCURRED SHALL BE AT THE EXPENSE OF THE CONTRACTOR.

CAUTION!!
EXIST. BURIED FIBER, TELEPHONE, CATV, GAS, ELECTRIC,
WATER, SANITARY SEWER & STORM SEWER FACILITIES IN
CONSTRUCTION AREA AND HAVE NOT BEEN FIELD LOCATED.
CONTRACTOR TO VERIFY EXACT LOCATION AND DEPTH
PRIOR TO ANY DIGGING AND/OR BORING.

NOTE: THE RIGHT-OF-WAY (ROW) SHOWN ON THESE PLANS IS BASED ON PUBLICLY AVAILABLE INFORMATION AND IS NOT EXACT. IT IS THE CONTRACTOR'S RESPONSIBILITY FOR ENSURING THAT ALL FACILITIES ARE CONSTRUCTED WITHIN THE ROW OR IN A COMMUNICATIONS EASEMENT. THE CONTRACTOR SHALL NOTIFY THE ENGINEER AND THE OWNER PRIOR TO CONSTRUCTION IF THERE ARE ANY CONCERNS REGARDING THE ROW.

**Spectrum**▶

LJA
LJA TELECOM

SPECTRUM
3993829
RDOF_TX_CLUSTER_2_TBD_WI56E
UPSHUR COUNTY
QSP PLAN

DESIGN BY: LJAT	CHECKED BY: JL
DRAWN BY: RC	APPROVED BY: KB
PROJECT NO: 2605-24-M32	SHEET: 20 OF 20
DATE: 12/11/2024	PAGE: 20

BIG SANDY, TX UPSHUR COUNTY

MATCHLINE - SEE SHEET 22

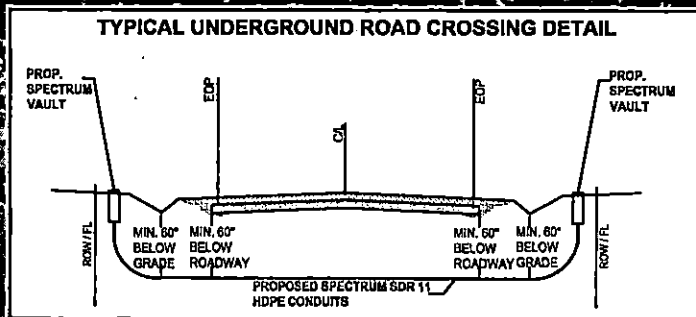
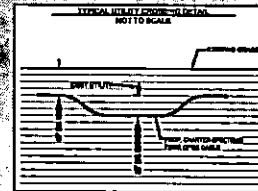
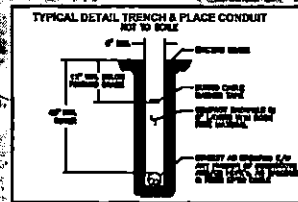
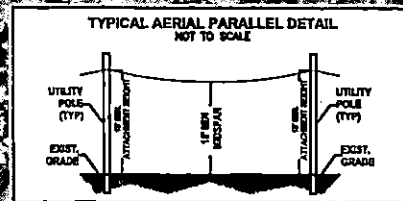
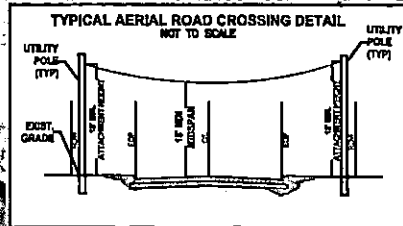

100 0 100 200
HORIZONTAL SCALE 1" = 200'

LEGEND

- PROP UNDERGROUND
- PROP AERIAL
- EX ROADWAY
- EX R.O.W.
- FENCE LINE
- ROW AND FENCE LINE
- EX EASEMENT
- EX WATER LINE
- EX WASTEWATER LINE
- EX STORM SEWER
- EX DITCH LINE
- EX ELECTRIC
- EX GAS
- EX TELECOM
- PROP. 24"X36"X24" VAULT
- PROP. 17"X 30"X 24" PCD
- EXISTING POLE
- POLE W/ RISER
- PROP ANCHOR

NOTE:
CONTRACTOR IS RESPONSIBLE TO MAINTAIN TRAFFIC CONTROL, AS SET FORTH IN THE TEXAS MANUAL ON UNIFORM TRAFFIC CONTROL DEVICES FOR STREET AND HIGHWAYS.

NOTE:
UNDERGROUND UTILITIES HAVE BEEN PLOTTED FROM AVAILABLE RECORDS AND FIELD OBSERVATIONS BUT ARE NOT NECESSARILY EXACT. IT IS THE CONTRACTOR RESPONSIBILITY TO FIELD LOCATE ALL UNDERGROUND OBSTRUCTIONS AND UTILITIES PRIOR TO CONSTRUCTION. COMPLETE REPAIR OF ANY AND ALL DAMAGES INCURRED SHALL BE AT THE EXPENSE OF THE CONTRACTOR.

CAUTION!!
EXIST. BURIED FIBER, TELEPHONE, CATV, GAS, ELECTRIC, WATER, SANITARY SEWER & STORM SEWER FACILITIES IN CONSTRUCTION AREA AND HAVE NOT BEEN FIELD LOCATED. CONTRACTOR TO VERIFY EXACT LOCATION AND DEPTH PRIOR TO ANY DIGGING AND/OR BORING.

NOTE: THE RIGHT-OF-WAY (ROW) SHOWN ON THESE PLANS IS BASED ON PUBLICLY AVAILABLE INFORMATION AND IS NOT EXACT. IT IS THE CONTRACTOR'S RESPONSIBILITY FOR ENSURING THAT ALL FACILITIES ARE CONSTRUCTED WITHIN THE ROW OR IN A COMMUNICATIONS EASEMENT. THE CONTRACTOR SHALL NOTIFY THE ENGINEER AND THE OWNER PRIOR TO CONSTRUCTION IF THERE ARE ANY CONCERNS REGARDING THE ROW.



Spectrum

LJA
LJA TELECOM

SPECTRUM
3993829
RDof_TX_CLUSTER_2.TBD_W516E
UPSHUR COUNTY
OSP PLAN

DESIGN BY: LJA/T	CHECKED BY: JL
DRAWN BY: RC	APPROVED BY: MB
PROJECT NO: 2605-24-W532	SHEET: 21 OF 29
DATE: 12/11/2024	PAGE: 21

CAUTION!!
CONTRACTOR TO LOCATE & VERIFY ALL EXISTING UTILITIES PRIOR TO CONSTRUCTION

MATCHLINE - SEE SHEET 22

12/17/2024 2:55:01 PM LJA\jlat\PROJECTS\UNITS-SPECTRUM\NORTH TEXAS\2024\2803-24-N132 ROW_TL_CLUSTER_2.TBD_WI56E UPSHUR COUNTY.dwg

BIG SANDY, TX
UPSHUR COUNTY

MATCHLINE - SEE SHEET 23

TYPICAL UNDERGROUND ROAD CROSSING DETAIL

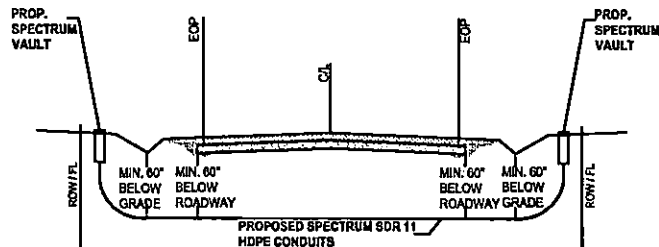

TYPICAL DETAIL TRENCH & PLACE CONDUIT
NOT TO SCALE

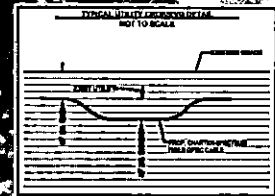
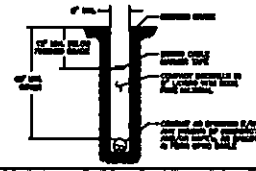

CAUTION !!!
CONTRACTOR TO LOCATE &
VERIFY ALL EXISTING UTILITIES
PRIOR TO CONSTRUCTION

100 0 100 200
HORIZONTAL SCALE: 1" = 200'

- LEGEND
- PROP UNDERGROUND
 - PROP AERIAL
 - EX ROADWAY
 - EX ROW/FL
 - FENCE LINE
 - ROW AND FENCE LINE
 - EX EASEMENT
 - EX WATER LINE
 - EX WASTEWATER LINE
 - EX STORM SEWER
 - EX DITCH LINE
 - EX ELECTRIC
 - EX GAS
 - EX TELECOM
 - PROP. 24" X 36" X 24" VAULT
 - PROP. 17" X 30" X 24" PED
 - EXISTING POLE
 - POLE W/ RISER
 - PROP ANCHOR

NOTE:
CONTRACTOR IS RESPONSIBLE TO MAINTAIN TRAFFIC
CONTROL AS SET FORTH IN THE TEXAS MANUAL ON
UNIFORM TRAFFIC CONTROL DEVICES FOR STREET AND
HIGHWAYS.

NOTE:
UNDERGROUND UTILITIES HAVE BEEN PLOTTED FROM
AVAILABLE RECORDS AND FIELD OBSERVATIONS BUT ARE
NOT NECESSARILY EXACT. IT IS THE CONTRACTOR
RESPONSIBILITY TO FIELD LOCATE ALL UNDERGROUND
OBSTRUCTIONS AND UTILITIES PRIOR TO CONSTRUCTION.
COMPLETE REPAIR OF ANY AND ALL DAMAGES INCURRED
SHALL BE AT THE EXPENSE OF THE CONTRACTOR.

CAUTION!!
EXIST. BURIED FIBER, TELEPHONE, CATV, GAS, ELECTRIC,
WATER, SANITARY SEWER & STORM SEWER FACILITIES IN
CONSTRUCTION AREA AND HAVE NOT BEEN FIELD LOCATED.
CONTRACTOR TO VERIFY EXACT LOCATION AND DEPTH
PRIOR TO ANY DIGGING AND/OR BORING.

NOTE: THE RIGHT-OF-WAY (ROW) SHOWN ON THESE PLANS IS BASED ON PUBLICLY
AVAILABLE INFORMATION AND IS NOT EXACT. IT IS THE CONTRACTOR'S
RESPONSIBILITY FOR ENSURING THAT ALL FACILITIES ARE CONSTRUCTED WITHIN
THE ROW OR IN A COMMUNICATIONS EASEMENT. THE CONTRACTOR SHALL NOTIFY
THE ENGINEER AND THE OWNER PRIOR TO CONSTRUCTION IF THERE ARE ANY
CONCERNS REGARDING THE ROW.



Spectrum

LJA
LJA TELECOM

SPECTRUM
3993829
RDOF_TX_CLUSTER_2.TBD_WI56E
UPSHUR COUNTY
OSP PLAN

DESIGN BY: LJA	CHECKED BY: J
DRAWN BY: RC	APPROVED BY: KB
PROJECT NO: 2803-24-N132	SHEET: 22 OF 29
DATE: 12/11/2024	PAGE: 22

MATCHLINE - SEE SHEET 23

MATCHLINE - SEE SHEET 25

BIG SANDY, TX
UPSHUR COUNTY

100 0 100 200
HORIZONTAL SCALE: 1" = 200'

LEGEND

- PROP UNDERGROUND
- PROP AERIAL
- EX ROADWAY
- EX R.O.W.
- FENCE LINE
- ROW AND FENCE LINE
- EX EASEMENT
- EX WATER LINE
- EX WASTEWATER LINE
- EX STORM SEWER
- EX DITCH LINE
- EX ELECTRIC
- EX GAS
- EX TELECOM
- PROP. 24"X36"X24" VAULT
- PROP. 17"X 30"X 24" PED
- EXISTING POLE
- POLE W/ RISER
- PROP ANCHOR

NOTE:
CONTRACTOR IS RESPONSIBLE TO MAINTAIN TRAFFIC CONTROL AS SET FORTH IN THE TEXAS MANUAL ON UNIFORM TRAFFIC CONTROL DEVICES FOR STREET AND BOULEVARDS.

NOTE:
UNDERGROUND UTILITIES HAVE BEEN PLOTTED FROM AVAILABLE RECORDS AND FIELD OBSERVATIONS BUT ARE NOT NECESSARILY EXACT. IT IS THE CONTRACTOR RESPONSIBILITY TO FIELD LOCATE ALL UNDERGROUND OBSTRUCTIONS AND UTILITIES PRIOR TO CONSTRUCTION. COMPLETE REPAIR OF ANY AND ALL DAMAGES INCURRED SHALL BE AT THE EXPENSE OF THE CONTRACTOR.

CAUTION!!!
EXIST. BURIED FIBER, TELEPHONE, CATV, GAS, ELECTRIC, WATER, SANITARY SEWER & STORM SEWER FACILITIES IN CONSTRUCTION AREA AND HAVE NOT BEEN FIELD LOCATED. CONTRACTOR TO VERIFY EXACT LOCATION AND DEPTH PRIOR TO ANY DIGGING AND/OR BORING.

NOTE: THE RIGHT-OF-WAY (ROW) SHOWN ON THESE PLANS IS BASED ON PUBLICLY AVAILABLE INFORMATION AND IS NOT EXACT. IT IS THE CONTRACTOR'S RESPONSIBILITY FOR ENSURING THAT ALL FACILITIES ARE CONSTRUCTED WITHIN THE ROW OR IN A COMMUNICATIONS EASEMENT. THE CONTRACTOR SHALL NOTIFY THE ENGINEER AND THE OWNER PRIOR TO CONSTRUCTION IF THERE ARE ANY CONCERNS REGARDING THE ROW.



Spectrum

LJA
LJA TELECOM

SPECTRUM
3993829
RDOF_TX_CLUSTER_2_2.TBD_WI56E
UPSHUR COUNTY
OSP PLAN

DESIGN BY: LJA	CHECKED BY: JL
DRAWN BY: RC	APPROVED BY: KB
PROJECT NO: 2605-24-N32	SHEET: 24 OF 29
DATE: 12/11/2024	PAGE: 24

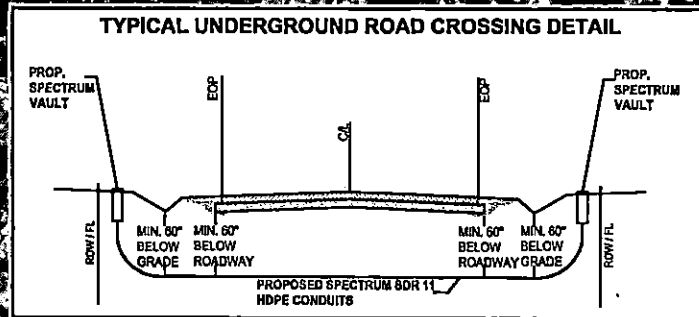
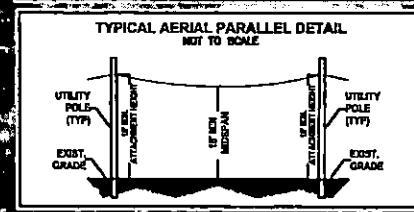
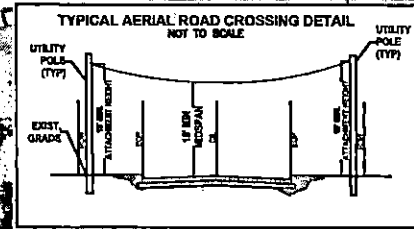

CAUTION!!!
CONTRACTOR TO LOCATE & VERIFY ALL EXISTING UTILITIES PRIOR TO CONSTRUCTION

MATCHLINE - SEE SHEET 23

12/11/2024 2:55:07 PM C:\Users\j\OneDrive\Documents\PROJECTS\WINTER-SPECTRUM\WINTER-SPECTRUM\UPSHUR COUNTY\UPSHUR COUNTY.dwg

BIG SANDY, TX
UPSHUR COUNTY

TYPICAL UNDERGROUND ROAD CROSSING DETAIL

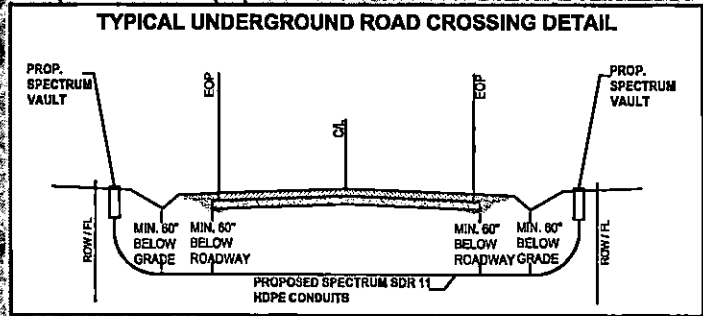

TYPICAL AERIAL ROAD CROSSING DETAIL
NOT TO SCALE

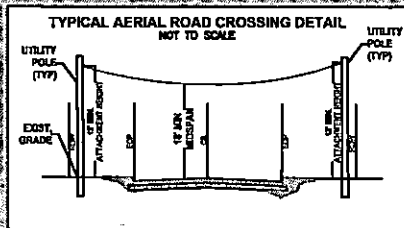

TYPICAL AERIAL PARALLEL DETAIL
NOT TO SCALE

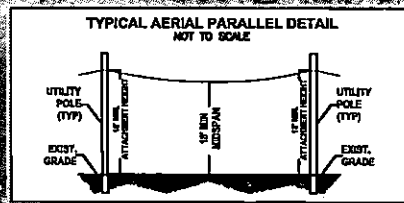

TYPICAL DETAIL TRENCH & PLACE CONDUIT
NOT TO SCALE

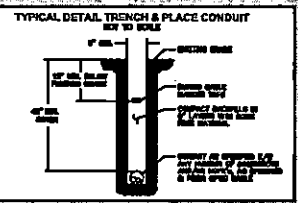

TYPICAL UTILITY CROSSING DETAIL
NOT TO SCALE

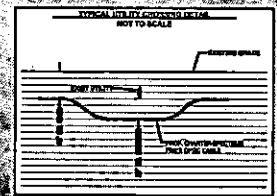

CAUTION !!!
CONTRACTOR TO LOCATE &
VERIFY ALL EXISTING UTILITIES
PRIOR TO CONSTRUCTION

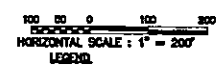

- LEGEND
- PROP. UNDERGROUND
 - PROP. AERIAL
 - EX. ROADWAY
 - EX. ROW
 - FENCE LINE
 - ROW AND FENCE LINE EX. EASEMENT
 - EX. WATER LINE
 - EX. WASTEWATER LINE
 - EX. STORM SEWER
 - EX. DITCH LINE
 - EX. ELECTRIC
 - EX. GAS
 - EX. TELECOM
 - PROP. 24" X 36" X 24" VAULT
 - PROP. 17" X 30" X 24" PED
 - EXISTING POLE
 - POLE W/ RISER
 - PROP. ANCHOR

NOTE:
CONTRACTOR IS RESPONSIBLE TO MAINTAIN TRAFFIC CONTROL AND SET FORTH IN THE TEXAS MANUAL ON UNIFORM TRAFFIC CONTROL DEVICES FOR STREET AND HIGHWAYS.

NOTE:
UNDERGROUND UTILITIES HAVE BEEN PLOTTED FROM AVAILABLE RECORDS AND FIELD OBSERVATIONS BUT ARE NOT NECESSARILY EXACT. IT IS THE CONTRACTOR RESPONSIBILITY TO FIELD LOCATE ALL UNDERGROUND OBSTRUCTIONS AND UTILITIES PRIOR TO CONSTRUCTION. COMPLETE REPAIR OF ANY AND ALL DAMAGES INCURRED SHALL BE AT THE EXPENSE OF THE CONTRACTOR.

CAUTION!!
EXIST. BURIED FIBER, TELEPHONE, CATV, GAS, ELECTRIC, WATER, SANITARY SEWER & STORM SEWER FACILITIES IN CONSTRUCTION AREA AND HAVE NOT BEEN FIELD LOCATED. CONTRACTOR TO VERIFY EXACT LOCATION AND DEPTH PRIOR TO ANY DIGGING AND/OR BORING.

NOTE: THE RIGHT-OF-WAY (ROW) SHOWN ON THESE PLANS IS BASED ON PUBLICLY AVAILABLE INFORMATION AND IS NOT EXACT. IT IS THE CONTRACTOR'S RESPONSIBILITY FOR ENSURING THAT ALL FACILITIES ARE CONSTRUCTED WITHIN THE ROW OR IN A COMMUNICATIONS EASEMENT. THIS CONTRACTOR SHALL NOTIFY THE ENGINEER AND THE OWNER PRIOR TO CONSTRUCTION IF THERE ARE ANY CONCERNS REGARDING THE ROW.



Spectrum



SPECTRUM
3993829
RDOF_TX_CLUSTER_2_TBD_WI56E
UPSHUR COUNTY
OSP PLAN

DESIGN BY:	LJAT	CHECKED BY:	JL
DRAWN BY:	RC	APPROVED BY:	KB
PROJECT NO:	2605-24-NI32	SHEET:	25 OF 28
DATE:	12/11/2024	PAGE:	25

MATCHLINE - SEE SHEET 25:

BIG SANDY, TX
UPSHUR COUNTY

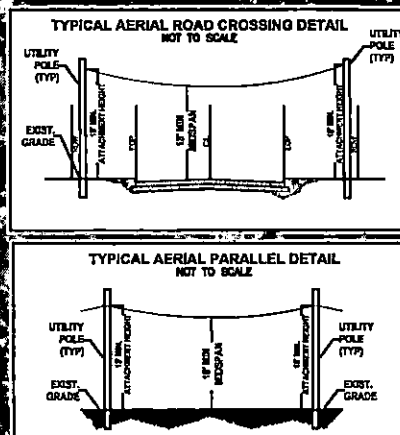

**CAUTION ON
CONTRACTOR TO LOCATE &
VERIFY ALL EXISTING UTILITIES
PRIOR TO CONSTRUCTION**

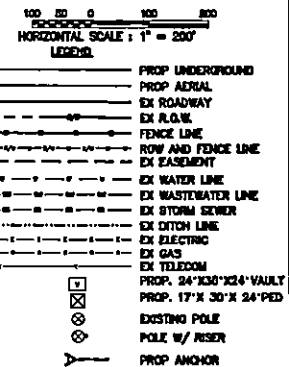

NOTE:
CONTRACTOR IS RESPONSIBLE TO MAINTAIN TRAFFIC CONTROL AS SET FORTH IN THE TEXAS MANUAL ON UNIFORM TRAFFIC CONTROL DEVICES FOR STREET AND HIGHWAYS.

NOTE:
UNDERGROUND UTILITIES HAVE BEEN PLOTTED FROM AVAILABLE RECORDS AND FIELD OBSERVATIONS BUT ARE NOT NECESSARILY EXACT. IT IS THE CONTRACTOR RESPONSIBILITY TO FIELD LOCATE ALL UNDERGROUND OBSTRUCTIONS AND UTILITIES PRIOR TO CONSTRUCTION. COMPLETE REPAIR OF ANY AND ALL DAMAGES INCURRED SHALL BE AT THE EXPENSE OF THE CONTRACTOR.

CAUTION!!!
EXIST. BURIED FIBER TELEPHONE, CATV, GAS, ELECTRIC,
WATER, SANITARY SEWER & STORM SEWER FACILITIES IN
CONSTRUCTION AREA AND HAVE NOT BEEN FIELD LOCATED.
CONTRACTOR TO VERIFY EXACT LOCATION AND DEPTH
PRIOR TO ANY DIGGING AND/OR BORING.

NOTE: THE RIGHT-OF-WAY (ROW) SHOWN ON THESE PLANS IS BASED ON PUBLICLY AVAILABLE INFORMATION AND IS NOT EXACT. IT IS THE CONTRACTOR'S RESPONSIBILITY FOR ENSURING THAT ALL FACILITIES ARE CONSTRUCTED WITHIN THE ROW OR IN A COMMUNICATIONS EASEMENT. THE CONTRACTOR SHALL NOTIFY THE ENGINEER AND THE OWNER PRIOR TO CONSTRUCTION IF THERE ARE ANY CONCERNS REGARDING THE ROW.



Spectrum

LJA
LJA TELECOM

SPECTRUM
3993829
RDOF_TX_CLUSTER_2_TBD_WI56E
UPSHUR COUNTY
OSP PLAN

DESIGN BY: LJAT	CHECKED BY: JL
DRAWN BY: RC	APPROVED BY: KB
PROJECT NO: 2605-24-N132	SHEET: 28 OF 29
DATE: 12/11/2024	PAGE: 28

MATCHLINE - SEE SHEET 28

BIG SANDY, TX
UPSHUR COUNTY

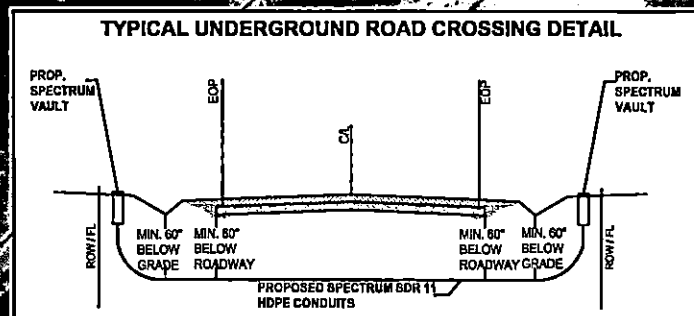
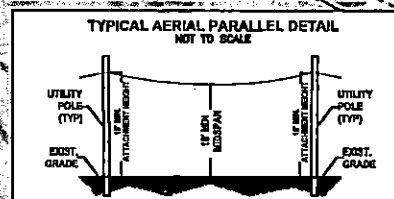
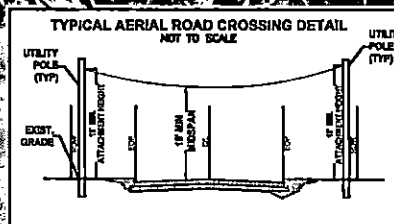
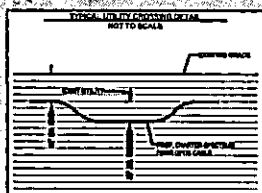
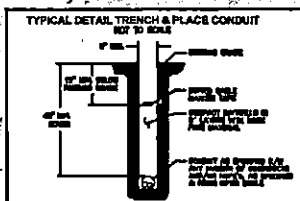

**CAUTION !!!
CONTRACTOR TO LOCATE &
VERIFY ALL EXISTING UTILITIES
PRIOR TO CONSTRUCTION**



LEAD: 1

-

NOTE:
CONTRACTOR IS RESPONSIBLE TO MAINTAIN TRAFFIC CONTROL AS SET FORTH IN THE TEXAS MANUAL ON UNIFORM TRAFFIC CONTROL DEVICES FOR STREET AND HIGHWAYS.

NOTE:
UNDERGROUND UTILITIES HAVE BEEN PLOTTED FROM AVAILABLE RECORDS AND FIELD OBSERVATIONS BUT ARE NOT NECESSARILY EXACT. IT IS THE CONTRACTOR RESPONSIBILITY TO FIELD LOCATE ALL UNDERGROUND OBSTRUCTIONS AND UTILITIES PRIOR TO CONSTRUCTION. COMPLETE REPAIR OF ANY AND ALL DAMAGES INCURRED SHALL BE AT THE EXPENSE OF THE CONTRACTOR.

CAUTION!!
EXIST. BURIED FIBER, TELEPHONE, CATV, GAS, ELECTRIC,
WATER, SANITARY SEWER & STORM SEWER FACILITIES IN
CONSTRUCTION AREA AND HAVE NOT BEEN FIELD LOCATED.
CONTRACTOR TO VERIFY EXACT LOCATION AND DEPTH
PRIOR TO ANY DIGGING AND/OR BORING.

NOTE: THE RIGHT-OF-WAY (ROW) SHOWN ON THESE PLANS IS BASED ON PUBLICLY AVAILABLE INFORMATION AND IS NOT EXACT. IT IS THE CONTRACTOR'S RESPONSIBILITY FOR ENSURING THAT ALL FACILITIES ARE CONSTRUCTED WITHIN THE ROW OR IN A CONVEYANCE EASEMENT. THE CONTRACTOR SHALL NOTIFY THE ENGINEER AND THE OWNER PRIOR TO CONSTRUCTION IF THERE ARE ANY CONCERNS REGARDING THE ROW.



Spectrum

LJA
LJA TELECOM

SPECTRUM
3993829
RDOF_TX_CLUSTER_2_TBD_WI56E
UPSHUR COUNTY
OSP PLAN

DESIGN BY: LJAT	CHECKED BY: JL
DRAWN BY: RC	APPROVED BY: KB
PROJECT NO: 2505-24-N132	SHEET: 27 OF 29
DATE: 12/11/2024	PAGE: 27

TYPICAL AERIAL ROAD CROSSING DETAIL
NOT TO SCALE

UTILITY POLE (TYP)

12' MIN. ATTACHMENT HEIGHT

12' MIN. CROSSSPAN

EXIST. GRADE

TYPICAL AERIAL PARALLEL DETAIL
NOT TO SCALE

UTILITY POLE (TYP)

12' MIN. ATTACHMENT HEIGHT

12' MIN. CROSSSPAN

EXIST. GRADE

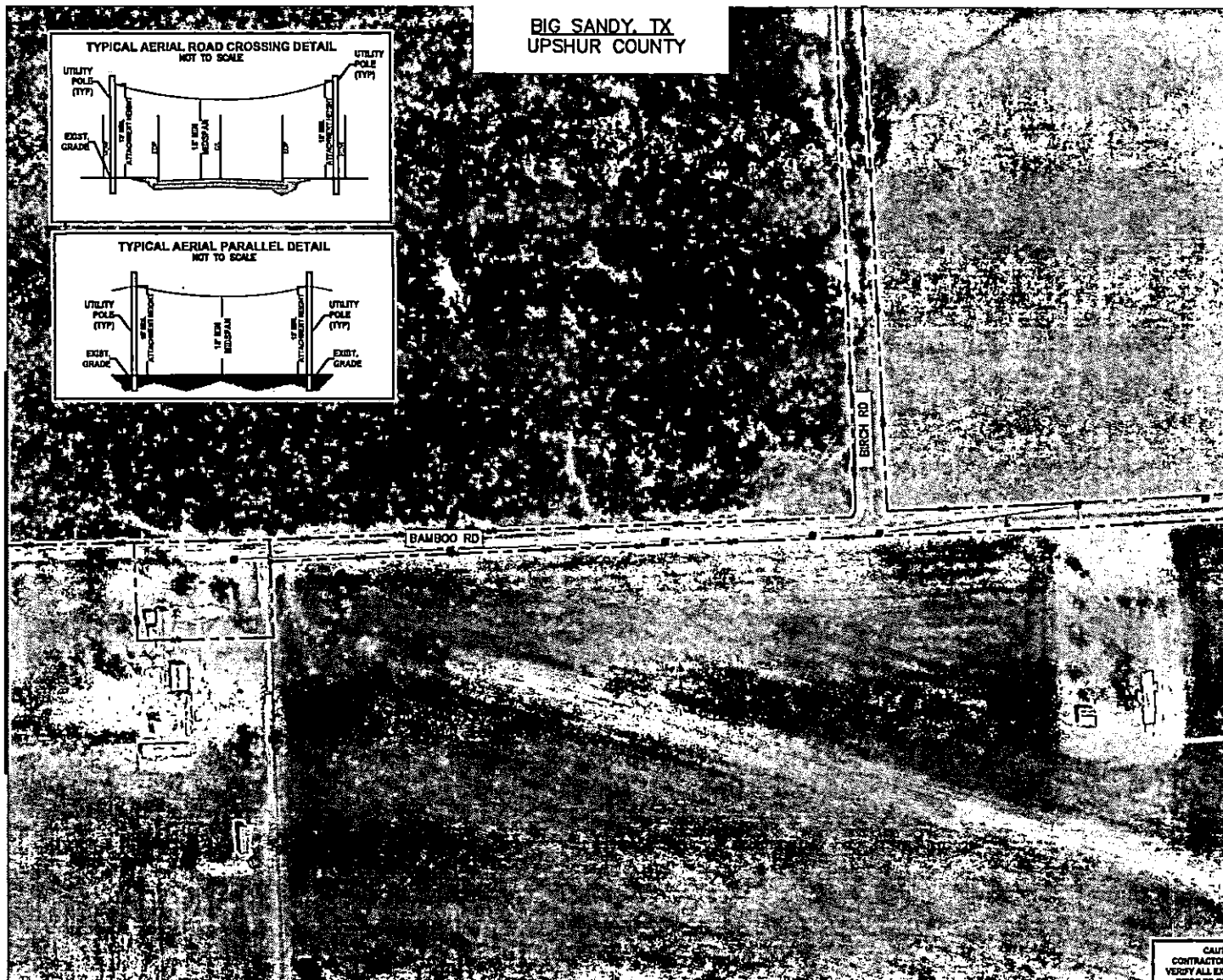

**CAUTION !!!
CONTRACTOR TO LOCATE &
VERIFY ALL EXISTING UTILITIES
PRIOR TO CONSTRUCTION**



15050

- 
 PROP UNDERGROUND
 PROP AERIAL
 EX ROADWAY
 EX R.O.W.
 FENCE LINE
 ROW AND FENCE LINE
 EX EASEMENT
 EX WATER LINE
 EX WASTE/WATER LINE
 EX STORM SEWER
 EX DITCH LINE
 EX ELECTRIC
 EX GAS
 EX TELECOM
 PROP. 24"X36"X24"VAULT
 PROP. 17"X 30"X 24"PIED
 EXISTING POLE
 POLE W/ RISER
 PROP ANCHOR

NOTE:
CONTRACTOR IS RESPONSIBLE TO MAINTAIN TRAFFIC CONTROL AS SET FORTH IN THE TEXAS MANUAL ON UNIFORM TRAFFIC CONTROL DEVICES FOR STREET AND HIGHWAYS.

NOTE:
UNDERGROUND UTILITIES HAVE BEEN PLOTTED FROM AVAILABLE RECORDS AND FIELD OBSERVATIONS BUT ARE NOT NECESSARILY EXACT. IT IS THE CONTRACTOR RESPONSIBILITY TO FIELD LOCATE ALL UNDERGROUND OBSTRUCTIONS AND UTILITIES PRIOR TO CONSTRUCTION. COMPLETE REPAIR OF ANY AND ALL DAMAGES INCURRED SHALL BE AT THE EXPENSE OF THE CONTRACTOR.

CAUTION!!
EXIST. BURIED FIBER, TELEPHONE, CATV, GAS, ELECTRIC,
WATER, SANITARY SEWER & STORM SEWER FACILITIES IN
CONSTRUCTION AREA AND HAVE NOT BEEN FIELD LOCATED
CONTRACTOR TO VERIFY EXACT LOCATION AND DEPTH
PRIOR TO ANY DIGGING AND/OR BORING.

NOTE: THE RIGHT-OF-WAY (ROW) SHOWN ON THESE PLANS IS BASED ON PUBLICLY AVAILABLE INFORMATION AND IS NOT EXACT. IT IS THE CONTRACTOR'S RESPONSIBILITY FOR ENSURING THAT ALL FACILITIES ARE CONSTRUCTED WITHIN THE ROW OR IN A COMMUNICATIONS EASEMENT. THE CONTRACTOR SHALL NOTIFY THE ENGINEER AND THE OWNER PRIOR TO CONSTRUCTION IF THERE ARE ANY CONCERNS REGARDING THE ROW.



Spectrum

LJA
LJA TELECOM

SPECTRUM
3993829
RDOF_TX_CLUSTER_2_TBD_WI56E
UPSHUR COUNTY
OSP PLAN

DESIGN BY: LJAT	CHECKED BY: JL
DRAWN BY: RC	APPROVED BY: KB
PROJECT NO: 2605-24-NJ32	SHEET: 28 OF 29
DATE: 12/11/2024	PAGE: 28

12/11/2024 2:25:07 PM S:\Users\ljohnson\My Recent Documents\PROJECTS\CLUSTER_2_TBD_W156E\UPSHUR\UPSHUR COUNTY.dwg

MATCHLINE - SEE SHEET 28

BIG SANDY, TX
UPSHUR COUNTY

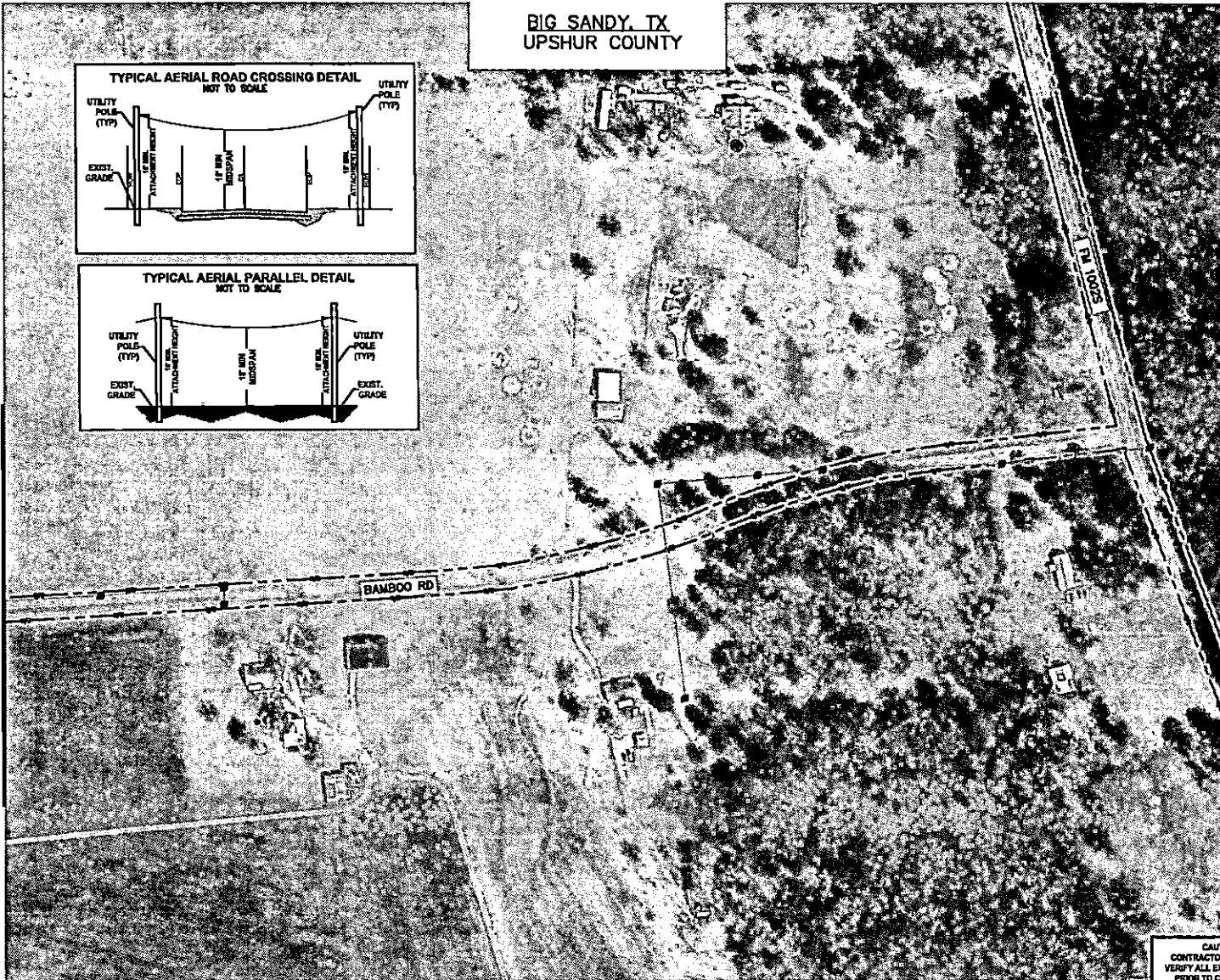
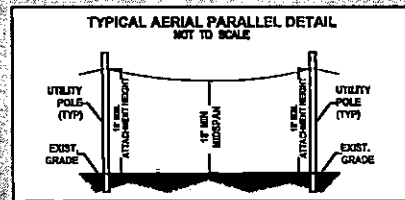
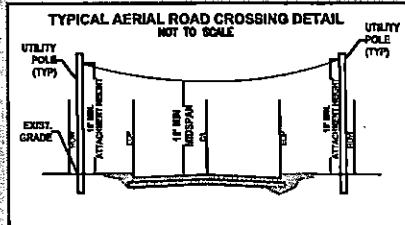

100 0 100 200
HORIZONTAL SCALE: 1" = 200'

LEGEND

- PROP. UNDERGROUND
- PROP. AERIAL
- EX. ROADWAY
- EX. R.O.W.
- FENCE LINE
- ROW AND FENCE LINE
- EX. EASEMENT
- EX. WATER LINE
- EX. WASTEWATER LINE
- EX. STORM SEWER
- EX. DITCH LINE
- EX. ELECTRIC
- EX. GAS
- EX. TELECOM
- PROP. 24" X 36" X 24" VAULT
- PROP. 17" X 30" X 24" PED
- EXISTING POLE
- POLE W/ RISER
- PROP. ANCHOR

NOTE:
CONTRACTOR IS RESPONSIBLE TO MAINTAIN TRAFFIC CONTROL AS SET FORTH IN THE TEXAS MANUAL ON UNIFORM TRAFFIC CONTROL DEVICES FOR STREET AND HIGHWAYS.

NOTE:
UNDERGROUND UTILITIES HAVE BEEN PLOTTED FROM AVAILABLE RECORDS AND FIELD OBSERVATIONS BUT ARE NOT NECESSARILY EXACT. IT IS THE CONTRACTOR'S RESPONSIBILITY TO FIELD LOCATE ALL UNDERGROUND OBSTRUCTIONS AND UTILITIES PRIOR TO CONSTRUCTION. COMPLETE REPAIR OF ANY AND ALL DAMAGES INCURRED SHALL BE AT THE EXPENSE OF THE CONTRACTOR.

CAUTION!
EXIST. BURIED FIBER, TELEPHONE, CATV, GAS, ELECTRIC, WATER, SANITARY SEWER & STORM SEWER FACILITIES IN CONSTRUCTION AREA AND HAVE NOT BEEN FIELD LOCATED. CONTRACTOR TO VERIFY EXACT LOCATION AND DEPTH PRIOR TO ANY DROPPING AND/OR BORING.

NOTE: THE RIGHT-OF-WAY (ROW) SHOWN ON THESE PLANS IS BASED ON PUBLICLY AVAILABLE INFORMATION AND IS NOT EXACT. IT IS THE CONTRACTOR'S RESPONSIBILITY FOR EMBANKING THAT ALL FACILITIES ARE CONSTRUCTED WITHIN THE ROW OR IN A CONVEYANCE EASEMENT. THE CONTRACTOR SHALL NOTIFY THE ENGINEER AND THE OWNER PRIOR TO CONSTRUCTION IF THERE ARE ANY CONCERNS REGARDING THE ROW.



Spectrum



SPECTRUM
3993829
RDOF_TX_CLUSTER_2_TBD_W156E
UPSHUR COUNTY
OSP PLAN

DESIGN BY:	LJAT	CHECKED BY:	JL
DRAWN BY:	RC	APPROVED BY:	KB
PROJECT NO:	2605-24-N132	SHEET:	29 OF 29
DATE:	12/11/2024	PAGE:	29

CAUTION !!!
CONTRACTOR TO LOCATE &
VERIFY ALL EXISTING UTILITIES
PRIOR TO CONSTRUCTION

APPROVAL

TO: Charter-Spectrum
6060 N Central Expwy, Suite 400
Dallas, TX 75206

DATE December 19, 2024

The Upshur County Commissioners Court offers no objections to the location on the right-of-way of your proposed 2-2" HDPE conduit line across Stable, Porter, Medlin, Salter, Eagles Nest Road as shown by accompanying drawings and notice dated December 19, 2024, except as noted below:

N/A

It is expressly understood that the Upshur County Commissioners Court does not purport, hereby, to grant and right, claim, title, or easement in or upon this county road; and it is further understood that in the future should for any reason Upshur County need to work, improve, relocate, widen, increase add to or any manner change the structure of this right-of-way line, this line, if affected, will be moved under the direction of the Upshur County Engineer and shall be relocated at the complete expense of the owner. Upshur County shall be notified a minimum of 48 hours prior to the beginning of any work.

All work on the county right-of-way shall be performed in accordance with the County Engineer's instructions. The installation shall not damage any part of the highway and adequate provisions must be made to cause minimum inconvenience to traffic and adjacent property owners. Special specifications for placing this line are as follows:

1. All ground lines are to be installed a minimum of 36 inches below the flowline of the adjacent drainage or borrow ditch.
2. All excavations within the right-of-way and not under surfacing shall be backfilled by tamping in 6 inch horizontal layers. All surplus material shall be removed from the right-of-way and the excavation finished flush with surrounding natural ground.
3. Lines crossing under surfaced roads and under surfaced cross roads within the right-of-way shall be placed by boring. Boring shall extend from crown line to crown line.
4. All lines under roads carrying pressure in excess of 50 psi shall be enclosed in satisfactory casing extending from right-of-way line to right-of-way line. Pipe used for casing may be of any type approved by the County Engineer and shall be capable of Supporting the load of roadbed and traffic and shall be so constructed that there will be no leakage of any matter through the casing for its entire length. Inside diameter of casing shall be at least 2 inches greater than the largest outside diameter of carrier pipe, joint or couplings. (Encasement is not required on lines installed 48 inches or greater below flowline.)
5. All lines, where practicable, shall be located to cross roadbed at approximately right angles thereto. No lines are to be installed under or within 50 feet of either end of a bridge unless approved by the County Engineer in writing. No lines shall be placed inside any culvert or within 10 feet of the closest point of same.
6. Parallel lines will be installed as near the right-of-way lines as is possible and no parallel line will be installed in the roadbed or between the drainage ditch and roadbed unless approved by the County Engineer in writing.
7. Overhead lines will have a minimum clearance of 18 feet above the road surface at point of crossing.
8. Operations along roadways shall be performed in such a manner that all excavated material be kept off the pavements at all times, as well as all operating equipment and materials. Do not use equipment or installation procedures which will damage any road surface or structure. The cost of any repairs to road surfaces, roadbed, structures or other right-of-way features as direct result of this installation will be borne by the owner of this line.
9. Barricades, warning signs, lights and flagmen, when necessary, shall be provided by the contractor or owner. One half of the traveled portion of the road must be open to traffic at all times. All traffic control shall be in accordance with the requirements of the current version of the Texas MUTCD.
10. Utility company shall install adequate erosion control measures for any excavation work being performed.

APPROVED: _____

Road Administrator

APPROVED: _____

Chairperson, Upshur County Commissioners Court
Revised 11/30/10

NOTICE OF PROPOSED INSTALLATION
PIPE AND/OR UTILITY LINES

TO: UPSHUR COUNTY COMMISSIONERS COURT
c/o UPSHUR COUNTY ENGINEER
UPSHUR COUNTY ROAD & BRIDGE DEPARTMENT
P. O. BOX 730
Gilmer, TX 75644

DATE: 12/17/2024

EXPIRES: _____

Formal notice is hereby given that Charter-Spectrum proposes to bore a 2-2" HDPE conduits line within the right-of-way of County Road Linda Loop as follows:
Stable Rd Charter-Spectrum is proposing to install approx. 11230' of underground conduits e/w
Porter Ln fiber optic cable, and place 34 vaults and 18 pedestals within the ROW of STABLE
E-Mountain N RD., PORTER LN., E-MOUNTAIN N, E-MOUNTAIN S, CIRCLE RIDGE RD,
E-Mountain S MEDLIN RD., SALTER LN. and EAGLES NEST
Circle Ridge Rd
Medlin Rd
Salter Ln
Eagles Nest

The location and description of the proposed line and appurtenances is more fully shown by three copies of drawings attached to this notice. The line will be constructed and maintained on the County right-of-way as directed by the County Engineer in accordance with current Upshur County specifications.

Construction of this line will begin on or after the 06 day of January, 2025 and will be completed within 90 days of the date of approval.

Firm Charter Spectrum
By James Roberts
Title Project Manager
Address 6060 N. Central Expwy, Suite 400
Dallas, TX 75206

- NOTE: 1. This form to be submitted in triplicate for each proposed installation.
2. The permit shall be in effect until the utility line is removed from the right of way.
3. Inform the County Engineer if work is not completed within this time.

MATCHLINE - SEE SHEET 3

LONGVIEW
UPSHUR COUNTY

TYPICAL UNDERGROUND ROAD CROSSING DETAIL

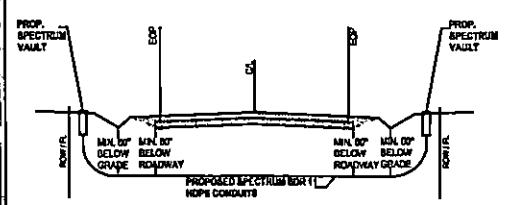

**TYPICAL DETAIL TRENCH & PLACE CONDUIT
NOT TO SCALE**

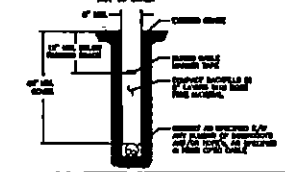

HOW TO SCALE

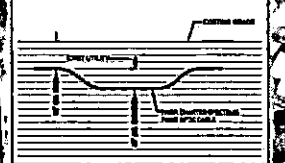

4



DEED

Legend for utility symbols and dimensions:

- PROP UNDERGROUND
- PROP AERIAL
- EX ROADWAY
- EX R.O.W.
- FENCE LINE
- RIDGE AND FENCE LINE
- EX EASEMENT
- EX WATER LINE
- EX WASTEWATER LINE
- EX STORM SEWER
- EX DITCH LINE
- EX ELECTRIC
- EX GAS
- EX TELECOM
- PROP. 24" X 36" X 24" VAULT
- PROP. 17" X 30" X 24" PED
- EXISTING POLE
- POLE W/ RISER
- PROP ANCHOR

NOTE:
CONTRACTOR IS RESPONSIBLE TO MAINTAIN TRAFFIC
CONTROL AS SET FORTH IN THE TEXAS MANUAL ON
UNIFORM TRAFFIC CONTROL DEVICES FOR STREET AND
HIGHWAYS.

NOTE:
UNDERGROUND UTILITIES HAVE BEEN PLOTTED FROM AVAILABLE RECORDS AND FIELD OBSERVATIONS BUT ARE NOT NECESSARILY EXACT. IT IS THE CONTRACTOR RESPONSIBILITY TO FIELD LOCATE ALL UNDERGROUND OBSTRUCTIONS AND UTILITIES PRIOR TO CONSTRUCTION. COMPLETE REPAIR OF ANY AND ALL DAMAGES INCURRED SHALL BE AT THE EXPENSE OF THE CONTRACTOR.

CAUTION!!
EXIST. BURIED FIBER, TELEPHONE, CATV, GAS, ELECTRIC,
WATER, SANITARY SEWER & STORM SEWER FACILITIES IN
CONSTRUCTION AREA AND HAVE NOT BEEN FIELD LOCATED.
CONTRACTOR TO VERIFY EXACT LOCATION AND DEPTH
PRIOR TO ANY DREDGING AND/OR BORING.

NOTE: THE RIGHT-OF-WAY (ROW) SHOWN ON THESE PLANS IS BASED ON PUBLICLY AVAILABLE INFORMATION AND IS NOT EXACT. IT IS THE CONTRACTOR'S RESPONSIBILITY FOR ENSURING THAT ALL FACILITIES ARE CONSTRUCTED WITHIN THE ROW OR IN A COMMUNICATIONS EASEMENT. THE CONTRACTOR SHALL NOTIFY THE ENGINEER AND THE OWNER PRIOR TO CONSTRUCTION IF THERE ARE ANY CONCERNS REGARDING THE ROW.

**Spectrum**▶

LJA
LJA TELECOM

SPECTRUM
3993812
RDOF TX CLUSTER 2 TBD W136E

OSP PLAN

DESIGN BY: LJAT	CHECKED BY: MA
DRAWN BY: EV	APPROVED BY: KB
PROJECT NO: 2005-24-NIT/4	SHEET: 4 OF 11
DATE: 12/11/2024	PAGE: 4

**CAUTION !!!
CONTRACTOR TO LOCATE &
VERIFY ALL EXISTING UTILITIES
PRIOR TO CONSTRUCTION**

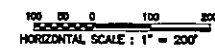

 PROP. UNDERGROUND
 PROP. AERIAL
 EX. ROADWAY
 EX. R.O.W.
 FENCE LINE
 PROP. AND FENCE LINE
 EX. EASEMENT
 EX. WATER LINE
 EX. WASTEWATER LINE
 EX. STORM SEWER
 EX. DITCH LINE
 EX. ELECTRIC
 EX. GAS
 EX. TELECOM
 PROP. 24"X36"X24" VAULT
 PROP. 17"X 30"X 24" FID
 EXISTING POLE
 POLE W/ RISER
 PROP. ANCHOR

NOTE:
CONTRACTOR IS RESPONSIBLE TO MAINTAIN TRAFFIC CONTROL AS SET FORTH IN THE TEXAS MANUAL ON UNIFORM TRAFFIC CONTROL DEVICES FOR STREET AND HIGHWAY.

NOTE:
UNDERGROUND UTILITIES HAVE BEEN PLOTTED FROM AVAILABLE RECORDS AND FIELD OBSERVATIONS BUT ARE NOT NECESSARILY EXACT. IT IS THE CONTRACTOR RESPONSIBILITY TO FIELD LOCATE ALL UNDERGROUND OBSTRUCTIONS AND UTILITIES PRIOR TO CONSTRUCTION. COMPLETE REPAIR OF ANY AND ALL DAMAGES INCURRED SHALL BE AT THE EXPENSE OF THE CONTRACTOR.

CAUTION!!!
EXIST. BURIED FIBER, TELEPHONE, CATV, GAS, ELECTRIC,
WATER, SANITARY SEWER & STORM SEWER FACILITIES IN
CONSTRUCTION AREA AND HAVE NOT BEEN FIELD LOCATED.
CONTRACTOR TO VERIFY EXACT LOCATION AND DEPTH
PRIOR TO ANY DIGGING AND/OR BORING.

NOTE: THE RIGHT-OF-WAY (ROW) SHOWN ON THESE PLANS IS BASED ON PUBLICLY AVAILABLE INFORMATION AND IS NOT EXACT. IT IS THE CONTRACTOR'S RESPONSIBILITY FOR ENSURING THAT ALL FACILITIES ARE CONSTRUCTED WITHIN THE ROW OR IN A COMMUNICATIONS EASEMENT. THE CONTRACTOR SHALL NOTIFY THE ENGINEER AND THE OWNER PRIOR TO CONSTRUCTION IF THERE ARE ANY CONCERNS REGARDING THIS ROW.

**Spectrum▶**

LJA
LJA TELECOM



















SPECTRUM
3993812
RDOF TX CLUSTER 2 TBD W136E

CSP PLAN

DESIGN BY: LJAY	CHECKED BY: MA
DRAWN BY: EV	APPROVED BY: KB
PROJECT NO: 2805-24-NT74	SHEET: 8 OF 11
DATE: 12/11/2024	PAGE: 8

**CAUTION ON
CONTRACTOR TO LOCATE &
VERIFY ALL EXISTING UTILITIES
PRIOR TO CONSTRUCTION**



 PROP UNDERGROUND
 PROP AERIAL
 EX ROADWAY
 EX R.O.W.
 FENCE LINE
 ROW AND FENCE LINE
 EX EASEMENT
 EX WATER LINE
 EX WASTEWATER LINE
 EX STORM SEWER
 EX DITCH LINE
 EX ELECTRIFIC
 EX GAS
 EX TELECOM
 PROP. 24'x36'x24' VAULT
 PROP. 17'x30'x24' PED
 EXISTING POLE
 POLE W/ RIDER
 PROP ANCHOR

NOTE:
UNDERGROUND UTILITIES HAVE BEEN PLOTTED FROM AVAILABLE RECORDS AND FIELD OBSERVATIONS BUT ARE NOT NECESSARILY EXACT. IT IS THE CONTRACTOR RESPONSIBILITY TO FIELD LOCATE ALL UNDERGROUND OBSTRUCTIONS AND UTILITIES PRIOR TO CONSTRUCTION. COMPLETE REPAIR OF ANY AND ALL DAMAGES INCURRED SHALL BE AT THE EXPENSE OF THE CONTRACTOR.

CAUTION: EXIST. BURIED FIBER, TELEPHONE, CATV, GAS, ELECTRICAL, WATER, SANITARY SEWER & STORM SEWER FACILITIES IN CONSTRUCTION AREA AND HAVE NOT BEEN FIELD LOCATED. CONTRACTOR TO VERIFY EXACT LOCATION AND DEPTH PRIOR TO ANY DITCHING AND/OR BORING.

NOTE: THE RIGHT-OF-WAY (ROW) SHOWN ON THESE PLANS IS BASED ON PUBLICLY AVAILABLE INFORMATION AND IS NOT EXACT. IT IS THE CONTRACTOR'S RESPONSIBILITY FOR ENSURING THAT ALL FACILITIES ARE CONSTRUCTED WITHIN THE ROW OR IN A COMMUNICATIONS EASEMENT. THE CONTRACTOR SHALL NOTIFY THE ENGINEER AND THE OWNER PRIOR TO CONSTRUCTION IF THERE ARE ANY CONCERNS REGARDING THE ROW.

**Spectrum▶**

LJA
LJA TELECOM

SPECTRUM
3993812
RDOF TX CLUSTER 2 TBD W136E

OSP PLAN

DESIGN BY: LJAT	CHECKED BY: MA
DRAWN BY: EV	APPROVED BY: KB
PROJECT NO: 2608-24-N174	SHEET: 6 OF 11
DATE: 12/11/2024	PAGE: 8

**CAUTION !!!
CONTRACTOR TO LOCATE &
VERIFY ALL EXISTING UTILITIES
PRIOR TO CONSTRUCTION**

MATCHLINE - SEE SHEET 10

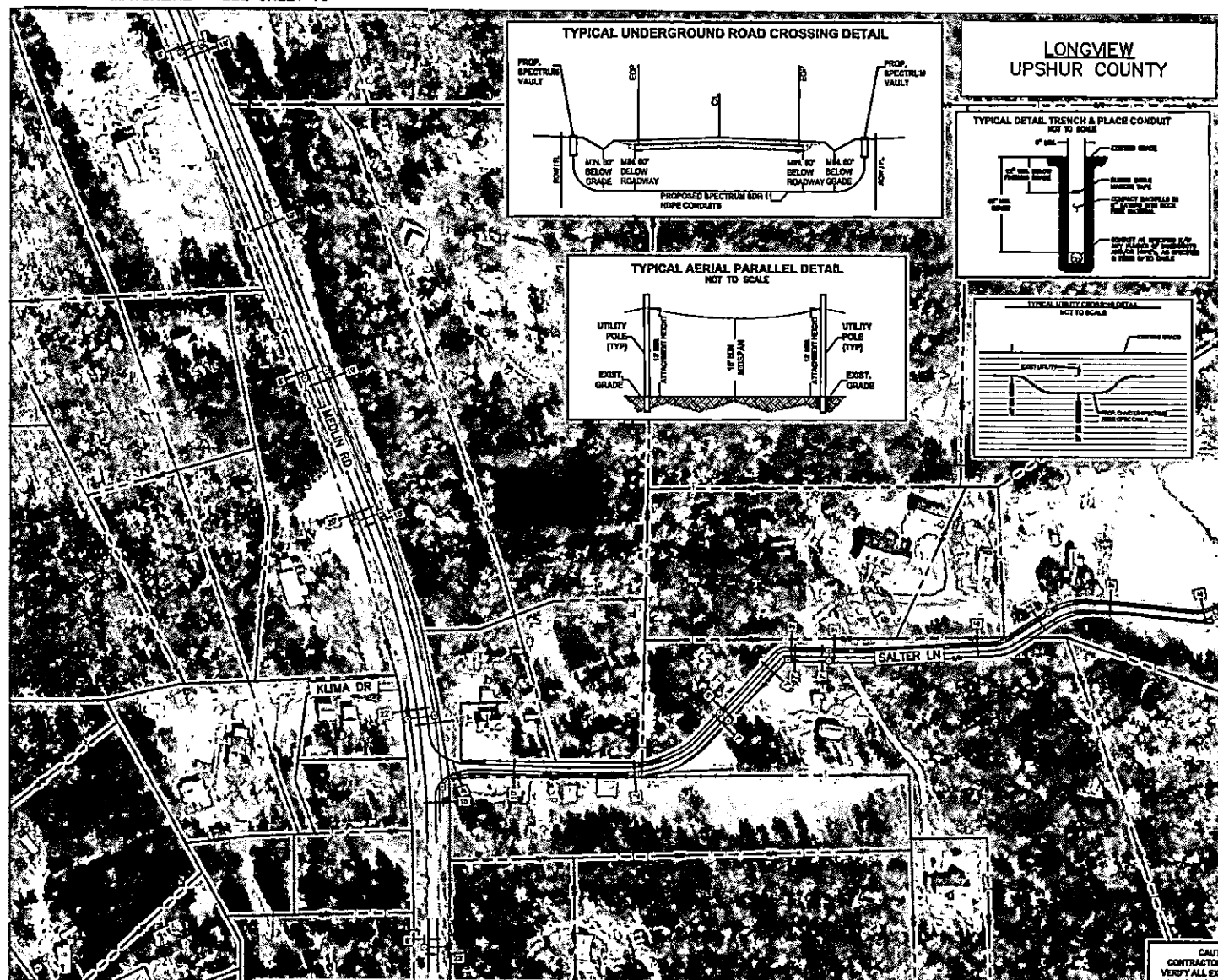

TYPICAL UNDERGROUND ROAD CROSSING DETAIL

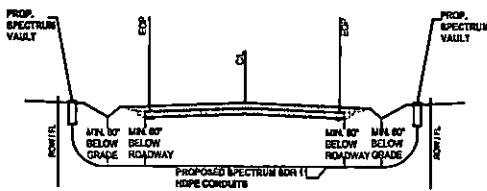

LONGVIEW
UPSHUR COUNTY

TYPICAL DETAIL TRENCH & PLACE CONDUIT

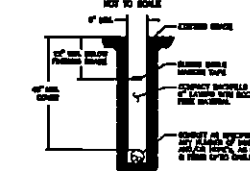

TYPICAL AERIAL PARALLEL DETAIL

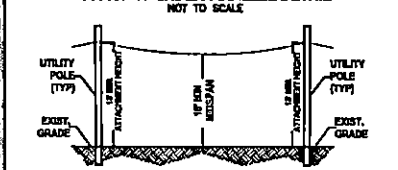

TYPICAL UTILITY CROSSING DETAIL

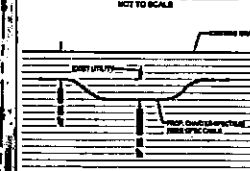

100 0 100 200
HORIZONTAL SCALE: 1" = 200'

LEGEND

- PROPOSED UNDERGROUND
- PROPOSED AERIAL
- EXIST. ROADWAY
- EXIST. R.O.W.
- FENCE LINE
- ROW AND FENCE LINE
- EXIST. EASEMENT
- EXIST. WATER LINE
- EXIST. WASTEWATER LINE
- EXIST. STORM SEWER
- EXIST. DITCH LINE
- EXIST. ELECTRIC
- EXIST. GAS
- EXIST. TELECOM
- PROPOSED 24"X36"X24" VAULT
- PROPOSED 17'X 30'X 24" PED
- EXISTING POLE
- POLE W/ RISER
- PROPOSED ANCHOR

NOTE:
CONTRACTOR IS RESPONSIBLE TO MAINTAIN TRAFFIC CONTROL AS SET FORTH IN THE TEXAS MANUAL ON UNIFORM TRAFFIC CONTROL DEVICES FOR STREET AND HIGHWAYS.

NOTE:
UNDERGROUND UTILITIES HAVE BEEN PLOTTED FROM AVAILABLE RECORDS AND FIELD OBSERVATIONS BUT ARE NOT NECESSARILY EXACT. IT IS THE CONTRACTOR'S RESPONSIBILITY TO FIELD LOCATE ALL UNDERGROUND OBSTRUCTIONS AND UTILITIES PRIOR TO CONSTRUCTION. COMPLETE REPAIR OF ANY AND ALL DAMAGES INCURRED SHALL BE AT THE EXPENSE OF THE CONTRACTOR.

CAUTION!
EXIST. BURIED FIBER, TELEPHONE, CATV, GAS, ELECTRIC, WATER, SEWANTARY SEWER & STORM SEWER FACILITIES IN CONSTRUCTION AREA AND HAVE NOT BEEN FIELD LOCATED. CONTRACTOR TO VERIFY EXACT LOCATION AND DEPTH PRIOR TO ANY DIGGING AND/OR BORING.

NOTE: THE RIGHT-OF-WAY (ROW) SHOWN ON THESE PLANS IS BASED ON PUBLICLY AVAILABLE INFORMATION AND IS NOT EXACT. IT IS THE CONTRACTOR'S RESPONSIBILITY TO FIELD LOCATE ALL UNDERGROUND OBSTRUCTIONS AND UTILITIES PRIOR TO CONSTRUCTION. COMPLETE REPAIR OF ANY AND ALL DAMAGES INCURRED SHALL BE AT THE EXPENSE OF THE CONTRACTOR.



Spectrum

LJA
LJA TELECOM

SPECTRUM
3993812

RDOF TX CLUSTER 2 TBD WI36E

CAUTION!!!
CONTRACTOR TO LOCATE & VERIFY ALL EXISTING UTILITIES PRIOR TO CONSTRUCTION

GSP PLAN

DESIGN BY: LJA	CHECKED BY: MA
DRAWN BY: EV	APPROVED BY: KB
PROJECT NO: 2503-24-WI36E	SHEET: 9 OF 11
DATE: 12/11/2024	PAGE: 9

MATCHLINE - SEE SHEET 8



TYPICAL UNDERGROUND ROAD CROSSING DETAIL

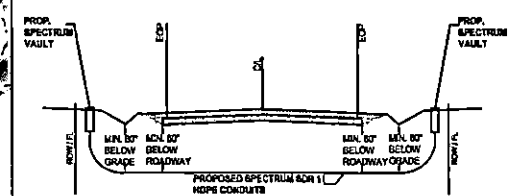

TYPICAL DETAIL TRENCH & PLACE CONDUIT

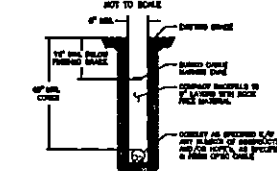

TYPICAL UTILITY CROSSING DETAIL
 NOT TO SCALE

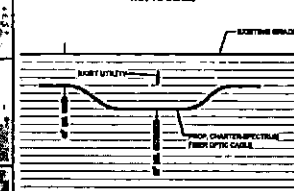



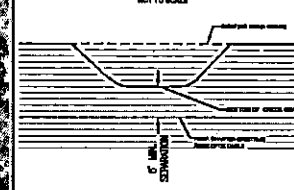















TYPICAL CYCLE REPORTING IN IAS



CAUTION (11)
CONTRACTOR TO LOCATE &
VERIFY ALL EXISTING UTILITIES
PRIOR TO CONSTRUCTION

HORIZONTAL SCALE : 1" = 200'

LEGEND

-  PROP UNDERGROUND
 PROP AERIAL
 EX ROADWAY
 EX R.O.W.
 FENCE LINE
 ROW AND FENCE LINE
 EX EASEMENT
 EX WATER LINE
 EX WASTEWATER LINE
 EX STORM SEWER
 EX DITCH LINE
 EX ELECTRIC
 EX GAS
 EX TELECOM
 PROP. 24'x36'x24' VAULT
 PROP. 17'x 30'x 24' PED
 EXISTING POLE
 POLE W/ RISER
 PROP ANCHOR

NOTE:
CONTRACTOR IS RESPONSIBLE TO MAINTAIN TRAFFIC CONTROL AS SET FORTH IN THE TEXAS MANUAL ON UNIFORM TRAFFIC CONTROL DEVICES FOR STREET AND HIGHWAYS.

NOTE:
UNDERGROUND UTILITIES HAVE BEEN PLOTTED FROM AVAILABLE RECORDS AND FIELD OBSERVATIONS BUT ARE NOT NECESSARILY EXACT. IT IS THE CONTRACTOR RESPONSIBILITY TO FIELD LOCATE ALL UNDERGROUND OBSTRUCTIONS AND UTILITIES PRIOR TO CONSTRUCTION. COMPLETE REPAIR OF ANY AND ALL DAMAGES INCURRED SHALL BE AT THE EXPENSE OF THE CONTRACTOR.

CAUTION!!
EXIST. BURIED FIBER, TELEPHONE, CATV, GAS, ELECTRIC,
WATER, SANITARY SEWER & STORM SEWER FACILITIES IN
CONSTRUCTION AREA AND HAVE NOT BEEN FIELD LOCATED.
CONTRACTOR TO VERIFY EXACT LOCATION AND DEPTH
PRIOR TO ANY DIGGING AND/OR BORING.

NOTE: THE RIGHT-OF-WAY (ROW) SHOWN ON THESE PLANS IS BASED ON PUBLICLY AVAILABLE INFORMATION AND IS NOT EXACT. IT IS THE CONTRACTOR'S RESPONSIBILITY FOR ENSURING THAT ALL FACILITIES ARE CONSTRUCTED WITHIN THE ROW OR IN A COMMUNICATIONS EASEMENT. THE CONTRACTOR SHALL NOTIFY THE ENGINEER AND THE OWNER PRIOR TO CONSTRUCTION IF THERE ARE ANY CONCERNS REGARDING THE ROW.

**Spectrum**▶

LJA
LJA TELECOM





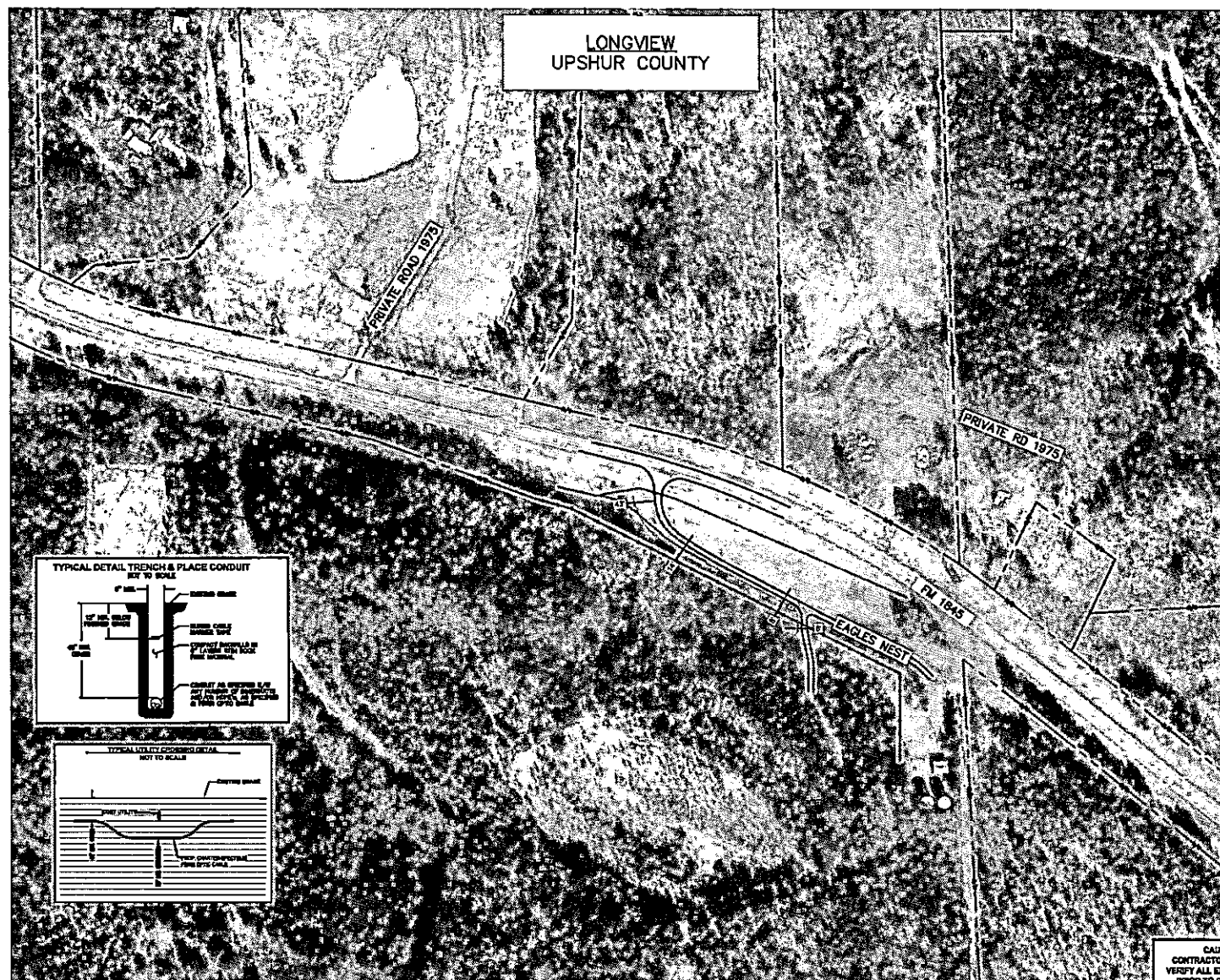













SPECTRUM
3993812
RDOF TX CLUSTER 2 TBD W/36E

OSP PLAN			
DESIGN BY:	LJAT	CHECKED BY:	MA
DRAWN BY:	EV	APPROVED BY:	KB
PROJECT NO:	2803-24-H74	SHEET:	10 OF 11
DATE:	12/11/2024	PAGE:	10



HORIZONTAL SCALE : 1" = 200'

LEGEND:

-  PROP UNDERGROUND
 PROP AERIAL
 EX ROADWAY
 EX R.O.W.
 FENCE LINE
 ROW AND FENCE LINE
 EX EASEMENT
 EX WATER LINE
 EX WASTEWATER LINE
 EX STORM SEWER
 EX DITCH LINE
 EX ELECTRIC
 EX GAS
 EX TELECOM
 PROP. 24"X36"X24" VAULT
 PROP. 17"X 30"X 24"PED
 EXISTING POLE
 POLE W/ RISER
 PROP ANCHOR

NOTE:
CONTRACTOR IS RESPONSIBLE TO MAINTAIN TRAFFIC CONTROL AS SET FORTH IN THE TEXAS MANUAL ON UNIFORM TRAFFIC CONTROL DEVICES FOR STREET AND HIGHWAY.

NOTE:
UNDERGROUND UTILITIES HAVE BEEN PLOTTED FROM AVAILABLE RECORDS AND FIELD OBSERVATIONS BUT ARE NOT NECESSARILY EXACT. IT IS THE CONTRACTOR RESPONSIBILITY TO FIELD LOCATE ALL UNDERGROUND OBSTRUCTIONS AND UTILITIES PRIOR TO CONSTRUCTION. COMPLETE REPAIR OF ANY AND ALL DAMAGES INCURRED SHALL BE AT THE EXPENSE OF THE CONTRACTOR.

CAUTION!!
EXIST. BURIED FIBER, TELEPHONE, CATV, GAS, ELECTRIC,
WATER, SANITARY SEWER & STORM SEWER FACILITIES IN
CONSTRUCTION AREA AND HAVE NOT BEEN FIELD LOCATED.
CONTRACTOR TO VERIFY EXACT LOCATION AND DEPTH
PRIOR TO ANY DIGGING AND/OR BORING.

NOTE: THE RIGHT-OF-WAY (ROW) SHOWN ON THESE PLANS IS BASED ON PUBLICLY AVAILABLE INFORMATION AND IS NOT EXACT. IT IS THE CONTRACTOR'S RESPONSIBILITY FOR ENSURING THAT ALL FACILITIES ARE CONSTRUCTED WITHIN THE ROW OR IN A COMMUNICATIONS EASEMENT. THE CONTRACTOR SHALL NOTIFY THE ENGINEER AND THE OWNER PRIOR TO CONSTRUCTION IF THERE ARE ANY CONCERNS REGARDING THE ROW.



Spectrum

LJA
LJA TELECOM

SPECTRUM
3993812
RDOF TX CLUSTER 2 TBD W/36E

OSP PLAN			
DESIGN BY:	LJAT	CHECKED BY:	MA
DRAWN BY:	EV	APPROVED BY:	KB
PROJECT NO:	2808-24-NIT4	SHEET:	11 OF 11
DATE:	12/11/2024	PAGE:	11

CAUTION !!!
CONTRACTOR TO LOCATE &
VERIFY ALL EXISTING UTILITIES
PRIOR TO CONSTRUCTION